

3

Prop #3

PROPERTY PLAT

Acquired from HERMAN WITT
(Name of owner must agree exactly with Name in which property stands of Record.)

Married or Single? _____ (Give full name of spouse)

R. O. W. Area 0.37 Acres.

Borrow Area _____ Acres. Total Consideration \$ _____

Acquired by _____ Date of Contract _____, 19____
(Easement—Deed—Condemnation—Contract)

LOCATION

From CL Station _____ to CL Station _____

Section 8, Township 80 N, Range 4 E

Township (Civil) BUTLER, County of SCOTT, Iowa.

A tract of land to be acquired for rd. purposes located in Sec. 8 T. 80 N. R. 4 E. of 5th. P.M. (Butler Twp.) more particularly described as follows; Comm. at the S.W. cor. of sd. Sec. 8, the pt. of beg. of tract herein described, thence N. 45.0 ft., thence E. 1324.89 ft. parallel to the S. line of sd. Sec. 8, thence S. 45.0 ft., thence W. 1324.89 ft. along the S. line of sd. Sec. 8, to the pt. of beg. containing 0.37 acres more or less exclusive of present established roads.

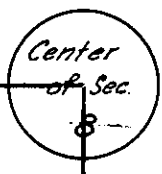

SW 1/4 Sec. 8-80-4

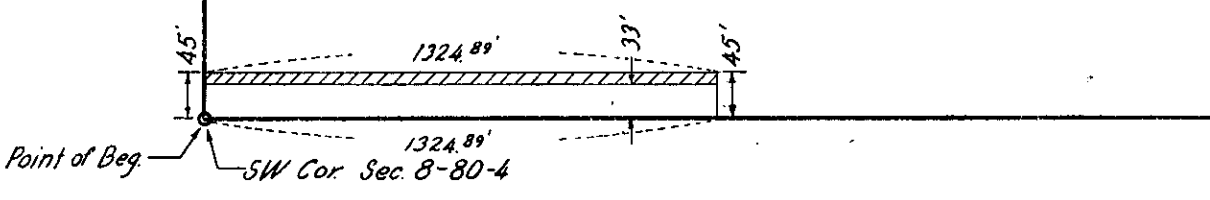

_____ Project No. S 1441 (2)
(County) SCOTT

RD # 66