

PLAT OF PROPERTY
RIGHT-OF-WAY FOR PUBLIC HIGHWAY

Acquired from RAYMOND C. WHITAKER
(Name of owner must agree exactly with Name in which property stands of Record.)

Married or Single? Dorothy W. Whitaker
(Give full name of spouse)

R. O. W. Area 0.36 Acres.

Borrow Area _____ Acres. Total Consideration \$ 188.⁰⁰

Acquired by easement Date of Contract July 8, 1946
(Easement—Deed—Condemnation)

LOCATION

From CL Station 361 + 71 to CL Sta. 374 + 23.1 Proj. No. S-265

Section 30

Township (Civil) Le Claire

Township (Congressional) 79 N Range S E

County Scott Iowa

Plat No 1 of 2

W $\frac{1}{4}$ Cor.

Center
Sec. 30

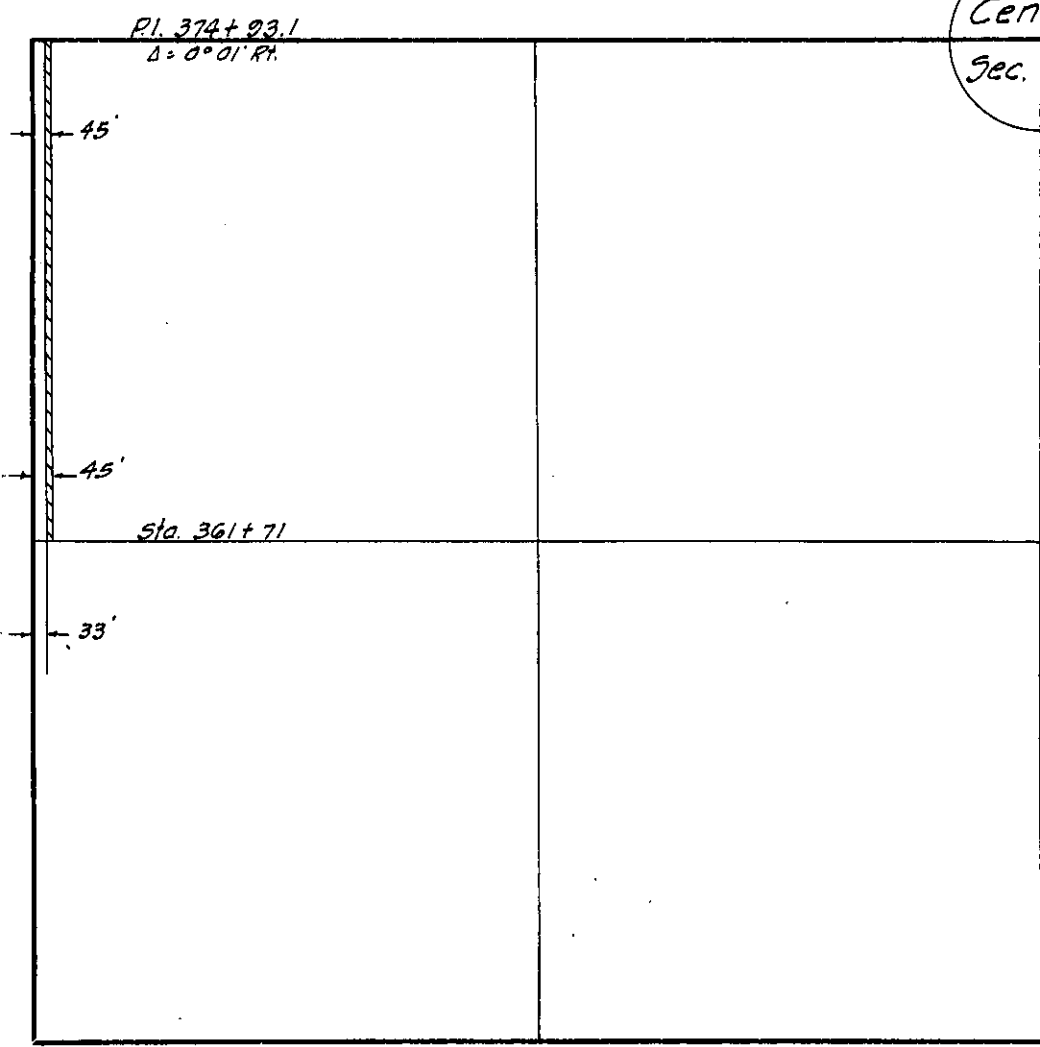

SCOTT
(County)

Project No. S - 265

1029

RD # 114

8-11-11