

PROPERTY PLAT

ACQUIRED FROM HELEN CLAUSSEN FILIASI

R.O.W. 0.15 ± ACRES CONSIDERATION \$ _____

BORROW _____ ACRES

ACQUIRED BY _____ CONTRACT DATED _____ 19____
EASEMENT - DEED - CONDEMNATION

LOCATION

FROM & STA. 19+75 TO & STA. 26+30.34

SECTION 29 TWP. 78N RANGE 3E

CIVIL TWP. DAVENPORT COUNTY SCOTT IOWA

N 1/4 COR.

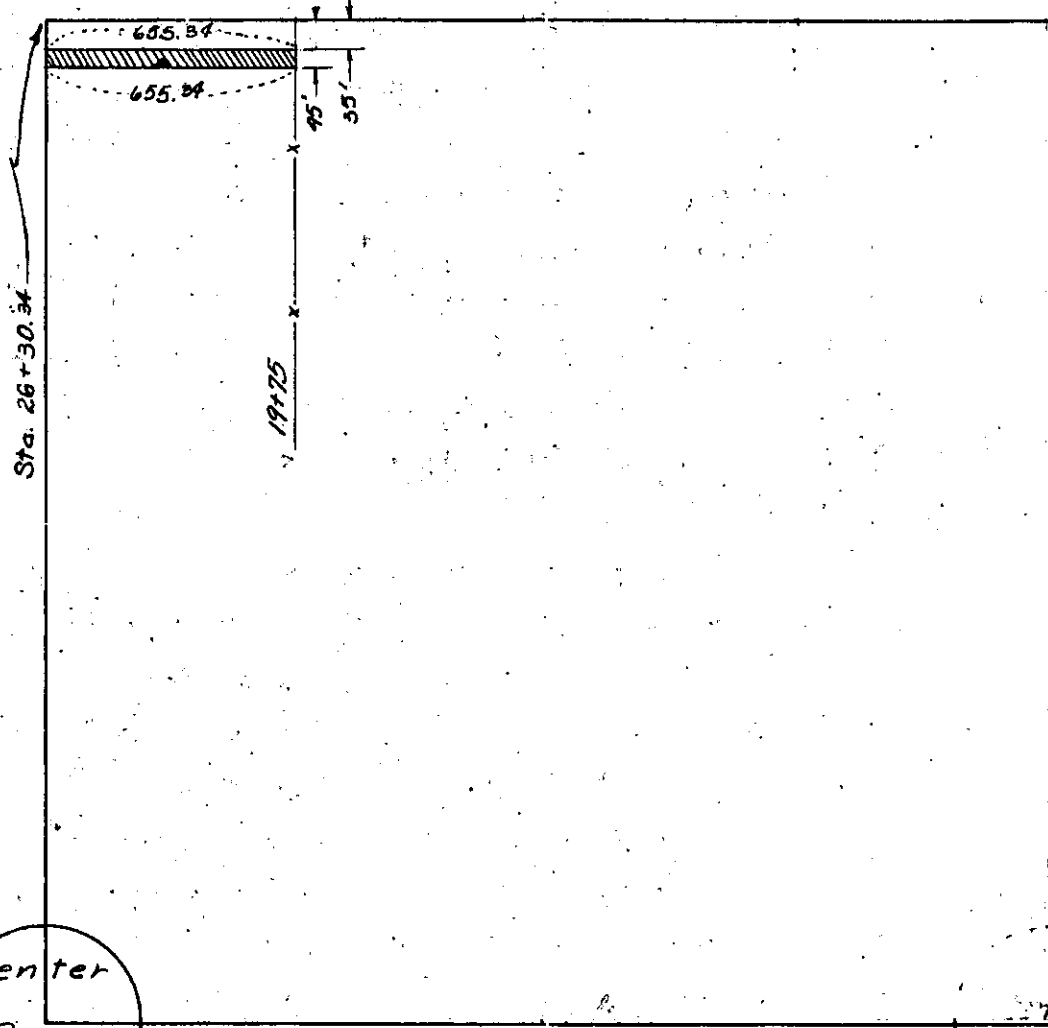

Center
Searns
S.C. 29