

# PROPERTY PLAT

ACQUIRED FROM Claus H. Ehlers

R.O.W. .15 ± ACRES CONSIDERATION \$ 28.72

BORROW \_\_\_\_\_ ACRES

ACQUIRED BY Easement CONTRACT DATED JAN. 27 1950  
EASEMENT - DEED - CONDEMNATION

## LOCATION

FROM & STA. 112+56 TO & STA. 119+16

SECTION 25 TWP. T78N RANGE R2E

CIVIL TWP. Blue Grass COUNTY Scott IOWA

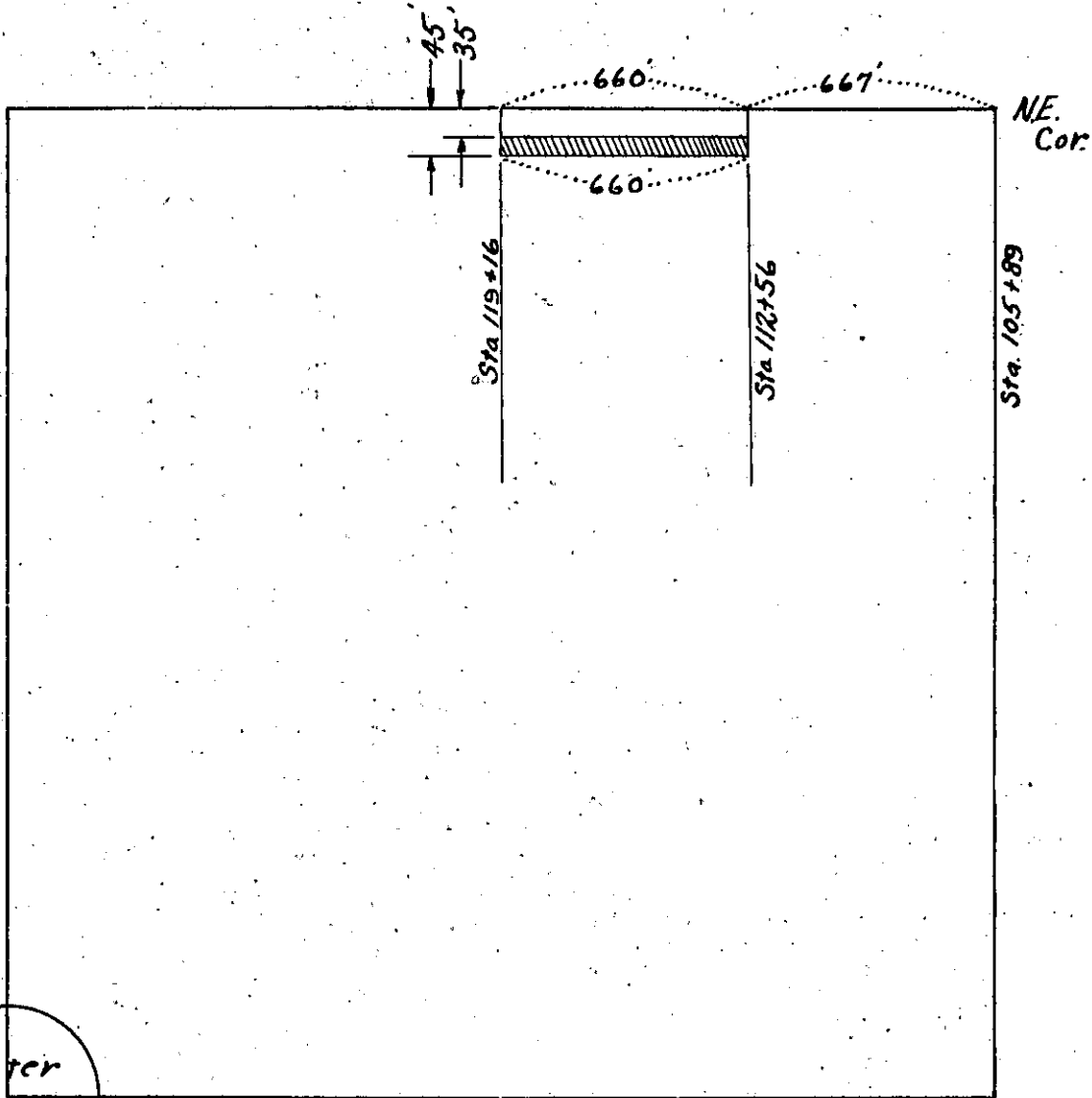

Center  
Sec. 25