

PROPERTY PLAT

ACQUIRED FROM Harry J. LeBuhn

R.O.W. 0.76± ACRES CONSIDERATION \$ 115.⁹²

BORROW _____ ACRES

ACQUIRED BY Easement CONTRACT DATED Feb. 3 1950
EASEMENT - DEED - CONDEMNATION

LOCATION

FROM & STA. 284+69⁰ TO & STA. 317+92³

SECTION 21 TWP. T-78-N RANGE R-2-E

CIVIL TWP. Blue Grass COUNTY SCOTT IOWA

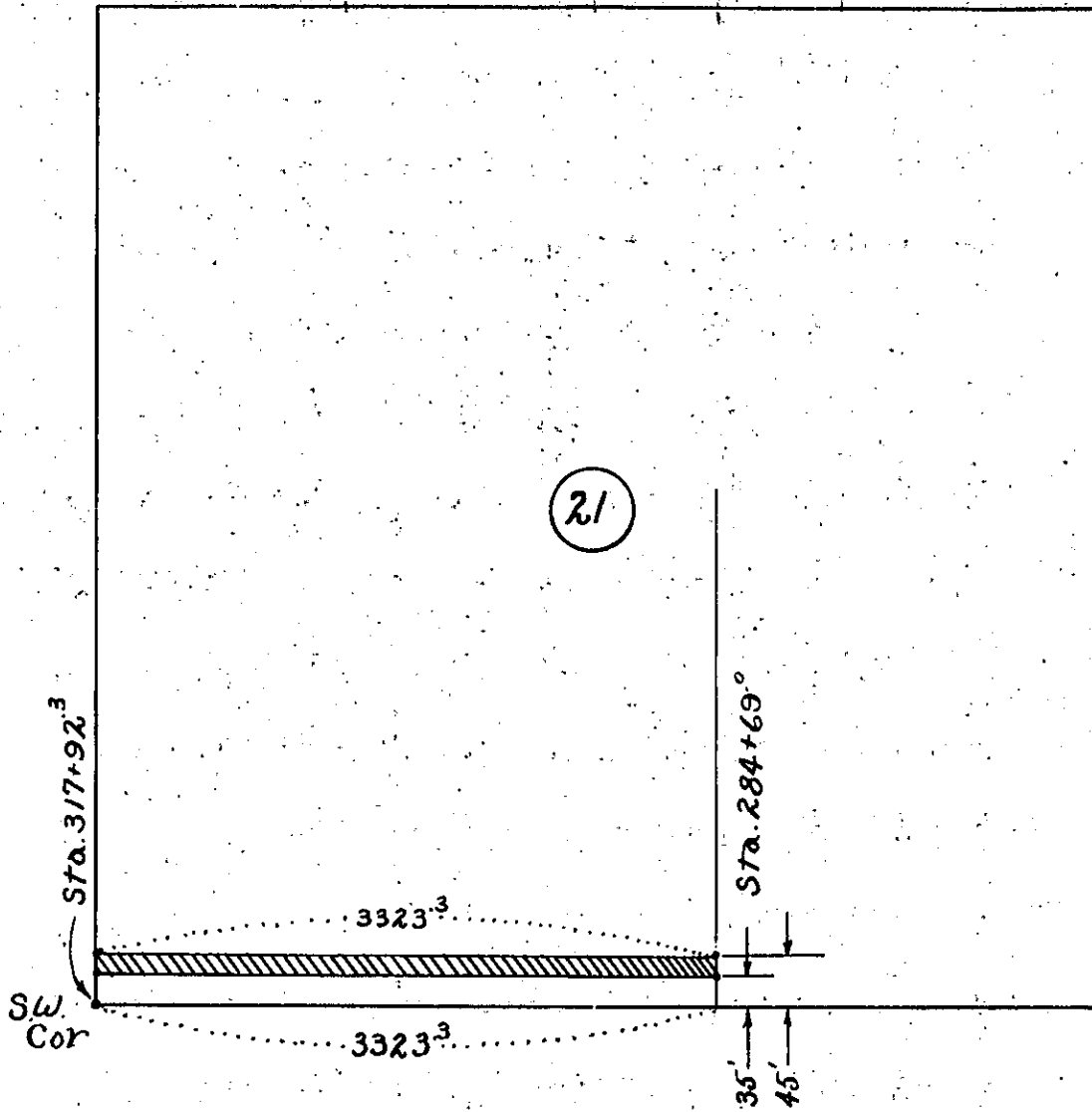

SCOTT

COUNTY

Rd. # 44 + 190
PROJECT NO. SN 1545