

Index Diagram to Township No 78th
 Range N 13 & 54 W Iowa.

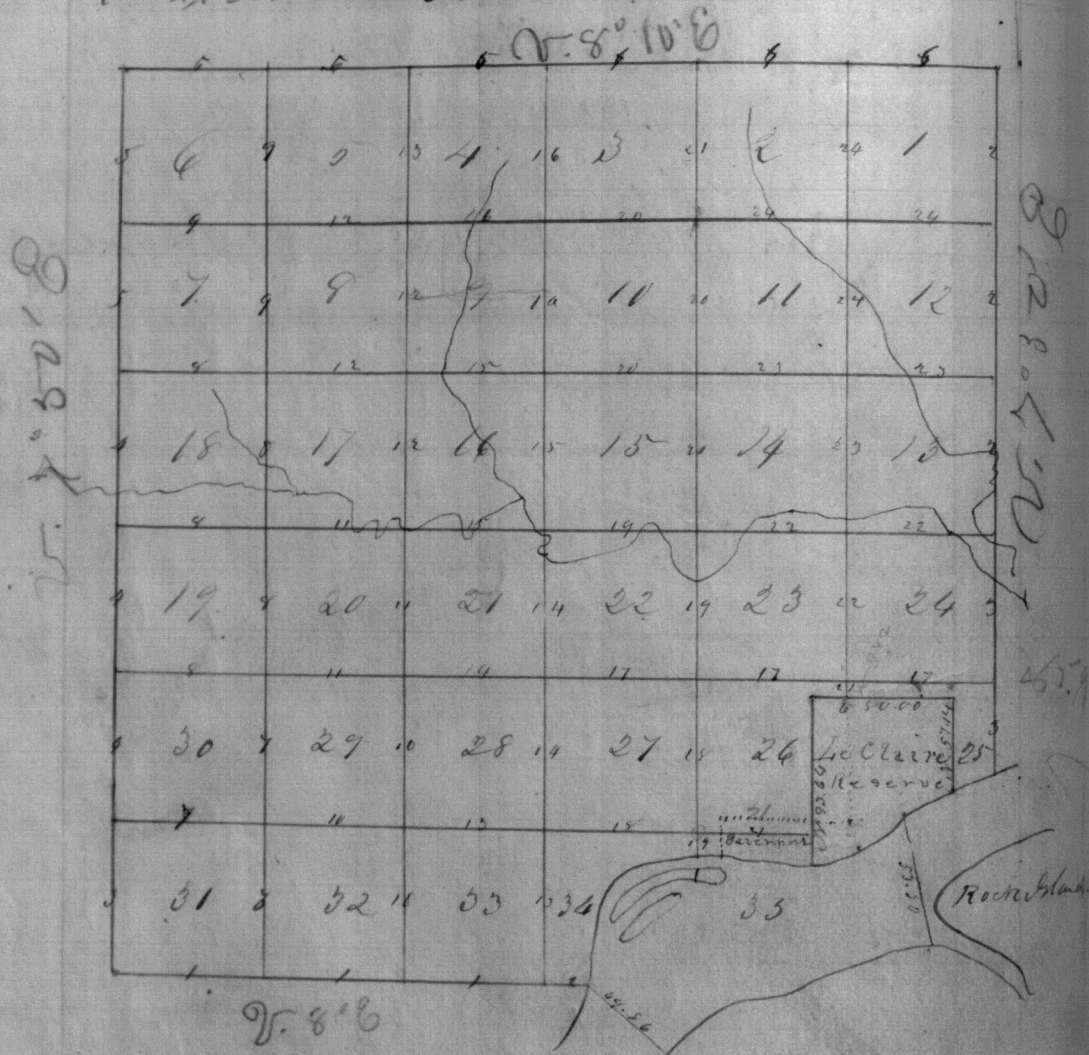

From the lands of Iowa Sec 25 186.
 From the lands of Iowa Sec 26 186.
 From the lands of Iowa Reserve Sec 27 186.

1
Dunstable No 78 Ramp No 6 5 PM Sun
Ch 24

Yonks Down damp

Went On the South side of Dec 32

- 5.50 To a field in S.
- 9.50 To a Hagm Road in line 16.
- 13.14 To a W Oak 25 min in dia.
- 35.51 To a W Oak 16 min in dia.
- 40.70 To a post at the gate
- At Oak 16 min in dia by 159.11.11
- At Oak 12 min in dia by 174.6.27.
- 65.96 To a Oak 14 min in dia
- 81.11 To a post at the Cor to Dec 29.132.
- At Oak 20 min in dia by 188.77.60
- At Oak 12 min in dia by 185.6.52.

Went On the South side of Dec 33.
Pan

- 10.00 To a Oak.
- 13.26 To a Oak 16 min in dia.
- 29.70 To a W Oak 20 min in dia.
- 37.00 To a Oak 3 lbs main in dia S.
- 40.00 To a post at the gate
- At Oak 8 min in dia by 147.19.30.
- At Oak 6 min in dia by 112.6.22.
- 56.00 Under a field near which is a house.
- 63.11 Near the field.
- 80.00 To a post at the Cor to Dec 32.150
- At Oak 30 min in dia by 142.6.6
- At Oak 10 min in dia by 186.7.77.

Went On the South side of Dec 33.
Pan

- 14.67 To a Oak 17 min in dia.
- 15.00 To a Swan 12 lbs main in dia S.

December 18th at Kansas City 5 PM
Chas. M. S.

- 16.75 To a Pond of brush from NW to SE.
- 39.25 To a Pond in NW to Rock Island.
- 40.00 Det a post at the gr see cor.
- 41.00 NW Oak 14 in in dia by N 92 E 67 1/2
- 41.00 SE Oak 10 in in dia by N 35 W 44 1/2
- 41.00 Enter a prairie bottom.
- 50.00 Det a post at the Cor to Dec 33 134 1/2
- 50.00 Made a mound of earth for a d.s.

East On the South Side of Dec 34.
Van

- 11.35 To a Run 4th mile in run S.
- 18.25 Enters Right Bank of Mississippi Run
- 18.25 by a meander for 1/2
- 18.25 A Maple 18 in in dia by S 63 W 47 1/2

East Boundary.

Established Dam Cor at 770 North
Cor to Run 79 1/2 N 36 W Run
South On the East Side of Dec 1
Van 7:50 P

- 40.00 Det a post at the gr see cor. No mound.
- 50.00 Det a post for the Cor to Dec 14 12 in diam.

South On the East Side of Dec 12
Van

- 40.00 Det a post at the gr see cor in prairie.
- 50.00 Det a post at the Cor to Dec 12 113 in diam.

South On the East Side of Dec 13
Van

- 38.10 To a Run 12th mile in run S.
- 40.00 Det a post for the gr see cor in prairie
- 43.00 To a Run 14th mile in run S.W.

Observations of the ...

- 43.75 North Van Creek 14 the ...
- 48.00 do do do do do
- 49.60 do do do do do
- 50.90 do do do do do
- 80.00 Detachment at the ...

South Creek East Side of Dec 24

- 13.60 To a stream 18 the ...
- 20.75 To the bend of same from the ...
- 24.00 To an ...
- 24.10 To a creek ...
- 40.00 Detachment at the ...
- At the ...
- At the ...
- 50.70 To a ...
- 80.00 Detachment at the ...
- At the ...
- At the ...

South Creek East Side of Dec 25

- 40.00 Detachment at the ...
- At the ...
- At the ...
- 56.59 To a ...
- 57.39 Entrance of Mississippi River ...
- At the ...
- At the ...

West Boundary

- South Creek East Side of Dec 36 ...

Journal of the 78th Kansas Co. & Co. P. M. Co.
Cooks

- 330 To a Sun. & the side of run at 6
- 4000 Det a spot at the gr. Sec cor
 Hickory 6 mi in dia. G 22: 13 184
 Hickory 6 mi in dia. G 17: 14 180.
- 7100 To a Sun. & the side of run etc.
- 7300 To a Sun. 12 the side of run E.
- 8100 Det a spot at the Cor to Sec 25 & 26.
 Hickory 6 mi in dia. G 29: 15 658
 to the Sun.

North on the East Side of Dec 35
Sun

- 1100 Det a spot at the gr. Sec cor
 Hickory 26 mi in dia. G 65: 13 59
 Hickory 5 mi in dia. G 14: 14 492.
- 8800 Enter a stream.
- 8900 Det a spot at the Cor to Sec 24 & 25
 made a mound of Earth & soil from
 a spot 3 the S.

North on the East Side of Dec 24
Sun

- 1100 Det a spot at the gr. Sec cor made
 a mound of Earth from a spot 2 the S.
- 9100 Det a spot at the Cor to Sec 13 & 24
 made a mound of Earth spot 2 the S.

North on the East Side of Dec 13.
Sun

- 1900 To a Sun. 12 the side of run E
- 4000 Det a spot at the gr. Sec cor made a mound
 of Earth from a spot 4 the S.
- 8200 Det a spot at the Cor to Sec 12 & 13. a spot 2 the
 Hickory 4 mi in dia. G 46: 11 55
 Hickory 5 mi in dia. G 50: 13

North West of the ...

North On the East Side of Dec 12

- 40.00 Det a part at the goose cor made a mound of earth from a pit 3 1/2 ft S.
- 81.00 Det a part at the Cor to Dec 12 made a mound of earth from a pit 3 1/2 ft S.

North On the East Side of Dec 1

- 40.00 Det a part at the goose cor made a mound of earth from a pit 4 1/2 ft S.
- 80.00 Det a part at the Cor to Dec 1 made a mound of earth from a pit 3 1/2 ft S.

North Boundary.

East On the South Side of Dec 31 1836

- 42.00 Det a part at the goose cor made a mound of earth from a pit 4 1/2 ft S.
- 82.00 Det a part at the Cor to Dec 31 1836 made a mound of earth from a pit 4 1/2 ft S.

East On the South Side of Dec 32

- 40.00 Det a part at the goose cor made a mound of earth from a pit 4 1/2 ft S.
- 42.50 Det a part at the ...
- 80.00 Det a part at the Cor to Dec 32 1836 made a mound of earth from a pit 4 1/2 ft S.

East On the South Side of Dec 33

- 17.00 Det a part at the ...

6
 Township No 78 of Range No 3 & 4 5th
 Dist

- 35.53 Center a mark is to N.W.
- 40.00 For a post with 90 Dec cor made a mound of Earth from a pit 4th 4.
- 44.00 Center the mark at the N.W.
- 80.00 For a post with Cor to Dec 33134. and made a mound of Earth from pit 4th 5.

East On the South Side of Dec 34

Per Am 8-156

- 40.00 For a post with 90 Dec cor made a mound of Earth from a pit 4th 6.
- 80.00 For a post at the Cor to Dec 34135 and made a mound of Earth from pit 4th 5.

East On the South Side of Dec 35,

Per Am

- 40.00 For a post at the 90 Dec cor made a mound of Earth from a pit 4th 6.
- 80.00 For a post with Cor to Dec 35136. and made a mound of Earth from pit 4th 5.

East On the South Side of Dec 36

Per Am. 8-056

- 7.50 For a Road is to N.E.
- 40.00 For a post with 90 Dec cor made a mound of Earth from a pit 4th 6.
- 73.05 For a Road is to N.E.
- 80.00 For a post at the Cor to Dec 36137 and made a mound of Earth from pit 4th 5.

Subdivision.

North On the East Side Dec 31132

Per Am

- 7.02 For a Road is to N.E.

7
Mantles of the ...

- 23.95 ...
- 36.42 ...
- 40.50 ...
- 41.2 ...
- 44.2 ...
- 55.45 ...
- 65.50 ...
- 90.00 ...

North ...

- 42.00 ...
- 80.05 ...

East ...

- 41.05 ...
- 48.75 ...
- 72.58 ...
- 80.05 ...

South ...

- 25.65 ...
- 40.00 ...
- 47.10 ...
- 90.00 ...

8
Parish of St. Louis Range No 36 & P. M. Co.
Chas. H. S.

West Handon on the Vine lot Dec 1910

Jan

29.75 Entered Range Vine at the Dec cor
East From Vine lot Dec 1910 -
39.50 by Dec lot in mound Feb 4th E.
29.75 by Dec cor.

West Cona Vine Vine lot Dec 1910

Jan

40.00 Put a post at the Dec cor & made
a mound of earth from a Feb 4th E.
36.80 To ploughed ground 11th E 11th S.
75.60 Near the ploughed ground (nearly on Dec 20)
81.00 Put a post at the Cor to Dec 17, 18, 19, 20
made a mound of earth from Feb 4th E.

West Handon on the Vine lot Dec 1819

Jan

81.00 Entered Range Vine 8th S of the Dec cor.

East Connected on the Vine lot Dec 1819

Jan

40.00 Put a post at the Dec cor & made a
mound of earth Feb 4th E
80.00 Put the post at the Cor to Dec 17, 18, 19, 20

North Conna Vine lot Dec 1918

Jan

2.75 To Luck Court 16th S made 8th S E side
35.00 To Adams 3th S side of 8th S E.
41.00 Put a post at the Dec cor & made
a mound of earth from a Feb 4th E.
51.00 Put a post at the Cor to Dec 7, 8, 11, 18
made a mound of earth Feb 4th E.

West Handon on the Vine lot Dec 1918

Jan

279.75
39.87

9
Mandibulo 18 D Pangkato & Co 57 Mac Lura
Cudd

3550 Carta a mark is to St
4120 Carta the mark is to St
6000 Carta thirly time and 1/2
80.09 Intense of Range limit Chart of Dec cor.

Cart. Connected on the Vin lot Dec 7/18
Jan

41.140 Det a prob at the 90 Dec cor 1000 a/c
a round of Earth from a pit 4 th 6
80.09 In the prob at the Cor to Dec 7. 8. 17. 18.

South On the Vin lot Dec 7/18
Jan

41.11 Det a prob at the 90 Dec cor 1000 a/c
a round of Earth from pit 4 th 5.

80.00 Det a prob at the Cor to Dec 5. 6. 7. 8. 17
made a round of Earth from pit 4 th 6.

West Standon on the Vin lot Dec 6/17
Jan

79.72 Intense of Range Vin 50. 100. 200. 300. 400. 500.

Cart. Connected on the Vin lot Dec 6/17
Jan

39. 86 Det a prob at the 90 Dec cor 1000 a/c
a round of Earth from a pit 4 th 6.

79.72 In the prob at the Cor to Dec 5. 6. 7. 18.

South On the Vin lot Dec 5/16
Jan

4000 Det a prob at the 90 Dec cor 1000 a/c
a round of Earth from a pit 4 th 6.

80.73 Intense of Range 842 th 11 of Cor to 310 200 100
Det a prob Cor to Dec 5/16 in round pit 4 th 6.

Parish No 78 of Range No 3 C & P Dec 1833
Ch 211

North On the Vine (Vob) Dec 1833,
Pan.

- 1250 Second the Bluff.
- 2200 Top of the Bluff.
- 2300 To a 1st Oak 24 m in dia.
- 4070 Put a post at the top of Dec cor.
1st Oak 28 m in dia by N 84 W 58 lb
2nd Oak 12 m in dia by N 73 W 6 73 lb
- 4192 To black Hawk Crank to run E.
- 4910 To a 1st Oak 26 m in dia.
- 8000 Put a post at the Cor to Dec 28 29 30 133,
at Hickory 7 m in dia by N 55 W 120 lb
at Hickory 11 m in dia by S 88 E 16 1 lb

West Range on the Vine (Vob) Dec 29 132
Pan
8012 Put a post at the top of Dec cor.

East Comedea on the Vine (Vob) Dec 29 132
Pan.
480 To a 1st Oak 4 m in dia.
4006 Put a post at the top of Dec cor made a
1st Oak 4 m in dia by N 10 E 46
2nd Oak 3 m in dia by S 7 E 24.
3374 To a 1st Oak 6 m in dia.
8012 Put a post at the Cor to Dec 28 29 30 133

North On the Vine (Vob) Dec 28 129
Pan
507 To a 1st Oak 10 m in dia.
3270 To a 1st Oak 12 m in dia.
4000 Put a post at the top of Dec cor
1st Oak 12 m in dia by S 18 W 112
2nd Oak 15 m in dia by N 8 E 78

Membership of 8th Kansas State Convention
The 16

90.00 Put a part at the Cor. to Dec 21, 28, 29.
At 13 Call 16 in in dia. 6 110. 1141.
At 13 Call 11 in in dia. 6 112. 1145.

West Kansas on the Vm to Dec 20, 29
Jan

90.04 Intused at Vm at Cor to Dec

East Connected on the Vm to Dec 20, 29
Jan

10.02 Put a part at the Cor Dec 20
At 11 Call 11 in in dia. 6 126. 6 90 lb
At 11 Call 16 in in dia. 6 40. 6 113 lb
90.04 Put a part at the Cor to Dec 20, 28, 29

South on the Vm to Dec 20, 29
Jan

Conte a part
11.00 Put a part at the Cor Dec 20, 28, 29 made a mound
of Earth from a part of the C.
90.00 Put a part at the Cor to Dec 21, 20, 21, 27
made a mound of Earth from a part of the C.

West Kansas on the Vm to Dec 17, 20
Jan

1.50 To Duck Creek 1/2 run to.
4.75 To do do 16 lb made runs S. E.
15.00 To do do do do do do
21.00 To do do do do do do
24.00 To do do do do do do
29.75 To do do do do do do

90.04 Intused at Vm 9 lbs. 1 of the Dec 20

East Connected on the Vm Dec 17, 20
Jan

Quadruped No 78 of Rancho 3 & S.P. On Con
Ch. 25

4103 Set a trap with the gr acc cor made a
mound of earth from a pit 4 lb C.
8054 Set a trap with the Cor to Dec 16. 17. 20. 121

Jack On the Vine Oct Dec 16 117
Day

38 1/2 Much Crust 10 lbs made by sun 14
4104 Set a trap with the gr acc cor made a
mound of earth from a pit 4 lb C.
8055 Set a trap with the cor to Dec 8. 9. 16. 17. 11
made a mound of earth pit 4 lb S.

West Rancho on the Vine Oct Dec 8 117
Day

8055 Intarsich W. Vine 4 3 lbs of cor.

East Concordia on the Vine Oct Dec 8 117
Day

4102 Set a trap with the gr acc cor made a mound
of earth from a pit 4 lb C.
8005 Set a trap with the Cor to Dec 8. 9. 16. 17.

Jack On the Vine Oct Dec 8 119
Day

33.50 Tea Steam 3 lbs made by sun SE
4101 Set a trap with the gr acc cor made a
mound of earth from a pit 4 lb C.
8050 Set a trap with the Cor to Dec 4. 5. 8. 9. 11
a mound of earth from a pit 4 lb S.

West Rancho on the Vine Oct Dec 8 119
Day

79.74 Intarsich W. Vine 25 lbs of the sugar

East Concordia on the Vine Oct Dec 8 119

University of Toronto Archives & Special Collections

3997 Det a part at the ... made a mound of earth from a pit ...
3998 Det a part at the ... made a mound of earth from a pit ...

Stack ... 415

4172 Det a part at the ... made a mound of earth from a pit ...
8000 Entrenchment ... 415 ...
Det a part in mound for ...

Stack ... 334

3350 ...
4000 Det a part at the ... made a mound of earth from a pit ...
8070 Det a part at the ... made a mound of earth from a pit ...

Wall ... 28133

2170 Det of the ...
2317 ...
2500 ...
4500 ...
8020 Entrenchment ...

Cart ...

2130 ...
4010 Det a part at the ...
...
Bele. 0.14 in dia EAST. ... Retaken by W.P. Campbell,

Summit 1178 Pandora & Co. W. Va.
Cash

51.00 To the post at the Cor. to Dec 27. 28. 29. 30.

South Central Virginia Feb Dec 27 18 29;
Pan

- 7.50 Meade Bluff. Clear Pr. cum.
- 16.12 To the top of the Bluff.
- 20.00 To the top of the Bluff.
- 34.00 To the top of the Bluff 10 mi. in dia.
- 40.00 To a point at the grade of the
W. Va. 15 mi. in dia. by 168. W. 80.
- 45.00 To a point at the grade of the
W. Va. 20 mi. in dia. by 176. W. 148.
- 62.00 To a point at the grade of the
W. Va. 5 mi. E of here.
- 90.00 To a point at the Cor. to Dec 21. 22. 27. 29.
(Notes do not mention any Cor.)

West Pandora on the Virginia Feb Dec 21 28
Pan

- 41.00 To a point at the grade of the
W. Va. 5 mi. E of here.
- 57.00 To a point at the grade of the
W. Va. 5 mi. E of here.
- 79.57 To a point at the grade of the
W. Va. 5 mi. E of here.

East Pandora on the Virginia Feb Dec 21 28
Pan

- 39.79 To a point at the grade of the
W. Va. 5 mi. E of here.
- 79.56 To a point at the Cor. to Dec 21. 22. 27. 29.

South Central Virginia Feb Dec 21 22
Pan

- 41.00 To a point at the grade of the
W. Va. 5 mi. E of here.
- 73.50 To a point at the grade of the
W. Va. 5 mi. E of here.
- 75.50 To do do do do do do
- 79.00 To do do do do do do

15

Membership in 18th St Range etc 26 5 1/2 m
Chart

80.00 Pot a foot at the Creek Dec 15, 16, 21, 22
made a mound of earth from pit 4 1/2 ft
on the left bank of Creek. Creek.

West Tandon on the line bet Dec 16 1914
1917

32.50 Veau Creek Creek in dam 6
47.50 To Creek Creek 16 by road survey 16
60.50 do do do do do do do do
76.00 Veau in the Creek.
78.50 Veau the Creek
79.75 Inters of 18th line 1/2 m of sec 10

East line of 18th line bet Dec 16 1914
1917

39.87 Pot a foot at the go Sec 10 made
a mound of earth from a pit 4 1/2 ft
79.75 Pot a foot at the Creek Dec 15, 16, 21, 22
the 18th line on the edge of Dec 21.

West line of 18th line bet Dec 15 1914
1917

40.00 Pot a foot at the go Sec 10 made
a mound of earth from pit 4 1/2 ft
80.00 Pot a foot at the Creek Dec 15, 16, 21, 22
Charada of Corn not noted in the notes
Supposed from topography to be a mound.

West Tandon on the line bet Dec 9 1914
1917

45.00 Opp only a small corner 15 cts,
this corner contains about 5 cgs.
50.50 To a line of the road (see p. 11)
79.84 Inters of 18th line 1/2 m of sec 10

Journal of the 1st Range to E & P in the
Creek

East Canada on the Line Feb Dec 9114
Jan

39.92 Set a post at the gr See cor made a
minute of each from a post 4th E.

79.84 Set a post at the Cor to Dec 31. 9114.

East Canada on the Line Feb Dec 9110

Jan

41.01 Set a post at the gr See cor made a
minute of each from a post 4th E

50.01 Set a post at the Cor to Dec 31. 9110
made a minute of each post 4th E.

West Canada on the Line Feb Dec 4119

Jan

32.40 To a stream 3 lbs made at runs E.

79.88 Intersect N. Line to back of the See cor.

East Canada on the Line Feb Dec 4119

Jan

39.94 Set a post at the gr See cor made a
minute of each from a post 4th E.

79.88 Set a post at the Cor to Dec 31. 9110.

East Canada on the Line Feb Dec 3114

Jan

41.01 Set a post at the gr See cor made
a minute of each from a post 4th E

57.30 To a road to N.W.

80.15 Intersect N. Line 846 the N of cor to 33154

Set a post at Cor to Dec 314 on a
minute of each from a post 4th E.

Membership of the Board of Trustees of the ...
Aug 15

East Rand on ...

9.50 ...

14.50 ...

61.50 ...

65.00 ...

80.00 ...

West ...

1000 ...

5000 ...

East ...

25.00 ...

60.50 ...

80.00 ...

West ...

1000 ...

8000 ...

East ...

14.25 ...

85.09 ...

West ...

Municipal Range No 3 & 5th Dec

- 10.55 Sea Cuckoo 9 m in dia.
- 35.30 Sea Noddy 5 m in dia.
- 43.09 Put a post at the gr sea cor mark
at Cuckoo 11 m in dia by 140° 19' 0"
- at Noddy 7 m in dia by 157° 25' 0"
- 55.09 Put a post at the Cor to Sea 23.24.25.26
made a mound of earth 2.4.4.4
at Noddy 4 m in dia by 182° 15' 0"

Work on the Vine Feb Dec 20 & 27.

- 25.10 Carta Dimber 15 m E S M.
- 37.18 Sea Noddy 15 m in dia.
- 41.11 Put a post at the gr sea cor mark
at Noddy 12 m in dia by 180° 14'
- at Noddy 12 m in dia by 181° 25'
- 42.54 Sea Noddy 12 m in dia.
- 51.50 Around the Bluffs.
- 52.50 To the foot of the Bluffs.
- 55.00 Carta a ploughed field of 1/2.
- 68.50 From the field to N. S.
- 81.00 Put a post at the Cor to Sea 26.27.34.35
at Noddy 10 m in dia by 185° 29'
- at Noddy 9 m in dia by 175° 28'.

Work on the Random Line Feb 27 184

- 12 Carta a mark B by N S M
- 12.00 From the mark to the ground
- 51.12 Carta of N S M 15 by 1/2 of sea cor

Work on the Vine Feb Dec 27 184.

- 40.00 Put a post at the gr sea cor

Plumbers 1878 of Kansas 365 M. Iowa
Cash

M^{rs} Oak 11 m in dia by 942 6 215

M^{rs} Oak 6 m in dia by 922 6 255

50.00 Put a post at the Cor to Dec 14 1878

Track on the Vm Feb Dec 34 1878

100

25.00 Made a mound of earth from Feb 4 to 6

6.00 Made the mound

13.98 To a M^{rs} Oak 13 m in dia

18.57 Entrance Mississippi River to the post
for the mound on the night of Dec 12

M^{rs} Oak 9 m in dia by 934 6 314

Track on the Vm Feb Dec 20 1878

100

24.50 Entrance mound on the Vm 3 ch 10

40.00 Put a post at the Cor to Dec 14 1878

M^{rs} Oak 6 m in dia by 919 6 31

M^{rs} Oak 6 m in dia by 915 6 190

36.68 To the track on the mound on the Vm

50.00 Put a post at the Cor to Dec 14 1878

Made a mound of earth from Feb 4 to 6

Had a mound on the Vm Feb Dec 15 1878

100

18.16 To the track on the mound on the Vm

23.12 To the track on the mound on the Vm

79.92 Entrance on the Vm 36 ch of Dec 10

4000
2647
1353

Entrance on the Vm Feb Dec 15 1878

100

39.94 Put a post at the Cor to Dec 14 1878
Mound of earth from Feb 4 to 6

79.92 To the post at the Cor to Dec 14 1878

21

Wardship of the W. P. P. & C. & S. D. M. & S. D. M. & S. D. M.

Wardship of the W. P. P. & C. & S. D. M. & S. D. M. & S. D. M.

Jan

4000 Put a post at the 90 Dec 14 1815
 a mound of earth from a pit 4 ft 6 in
 65.00 Put a post at the Cor to Dec 10. 11. 14 1815
 177 Oak 6 in in dia. by 14 to 22 ft
 178 Oak 6 in in dia. by 18 to 36 ft

Wardship of the W. P. P. & C. & S. D. M. & S. D. M. & S. D. M.

Jan

3000 Put a post at the 90 Dec 14 1815
 91.13 Interchange of W. P. P. & C. & S. D. M. & S. D. M. & S. D. M.

Wardship of the W. P. P. & C. & S. D. M. & S. D. M. & S. D. M.

Jan

4000 Put a post at the 90 Dec 14 1815
 a mound of earth from a pit 4 ft 6 in
 63.09 Put a post at the Cor to Dec 10. 11. 14 1815
 81.13 Put a post at the Cor to Dec 10. 11. 14 1815

Wardship of the W. P. P. & C. & S. D. M. & S. D. M. & S. D. M.

Jan

34.00 Put a post at the 90 Dec 14 1815
 4000 Put a post at the 90 Dec 14 1815
 a mound of earth from a pit 4 ft 6 in
 5000 Put a post at the Cor to Dec 2. 3. 10 1815
 a mound of earth from a pit 4 ft 6 in

Wardship of the W. P. P. & C. & S. D. M. & S. D. M. & S. D. M.

Jan

41.75 Put a post at the 90 Dec 14 1815
 5000 Interchange of W. P. P. & C. & S. D. M. & S. D. M. & S. D. M.

Journal of the West of Kansas 2 & 5 m. from
the 1st

East Connected on the Union Dec 31 11

4000 Set a post at the 92 sec cor made a
ground of bench from a post 4 1/2 c.
8000 Set a post at the Cor the Dec 23 11 11.

South on the Union Dec 21 11

4000 Set a post at the 99 sec cor made a
ground of bench from a post 1 1/2 c.
7992 Intersected by 852 the 11 of sec cor
Set a post for Cor the Dec 21 11 made
a ground of bench from a post 4 1/2 c.

South on the Union Dec 23 11

842 Intersected at Union of Antoin 26 11
Kearney Dec 26 11 of from 1 1/2 c.
the Cor the 18 m in sec 6 1/2 160 15

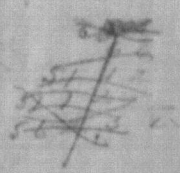

17.50 Road to
15.00 Second Right Bank of Union
15.00 Top of Right Bank of the
8000 Temporary post

8.42
66
50 5 2
508 2
555.7 2
264.7

West Road on the Union 11 Dec 26 11

8000 Intersected at Union 12 the 11 of Dec cor

East Connected on the Union Dec 26 11

4000 Set a post for the 92 sec cor made a
ground of bench from a post 4 1/2 c.
5470 Intersected Antoin 26 11 from
the Cor on the Union Set a post in ground of
bench from a post 4 1/2 c.

Principis No 78 A Camp do 3 e 4 de P. 1824

Bank on the Vine Feb Dec 30 1824
Van

- 50 Van Chensings
- 4000 Van a great with the Dec 30 1824 made a
memoir of each from a post 4 lb 6.
- 8150 Van a great with the Dec 30 1824 made a
memoir of each from a post 4 lb 6.

West Freedom on the Vine Feb Dec 14 1825
Van

- *39.98 Van a great with the Dec 30 1824 made a
memoir of each from a post 4 lb 6
- 79.96 Antaresch 10 lbs Sep Dec 30 1824

East Freedom on the Vine Dec 14 1825
Van

- 39.98 Van a great with the Dec 30 1824 made a
memoir of each from a post 4 lb 6.
- 79.96 Antaresch 10 lbs Sep Dec 30 1824

East Freedom on the Vine Dec 13 1824
Van

- 49.00 Dutch Quack 20 lbs made from 54
- 74.25 To a Swan of the same run of 14
- 84.12 Antaresch 10 lbs Sep Dec 30 1824

West Freedom on the Vine Feb Dec 13 1824
Van

- 44.12 Van a great with the Dec 30 1824 made a
memoir of each from a post 4 lb 6
- 84.12 Dutch Quack 20 lbs made from 54

* (This grade of wax has not been made
on the Freedom Vine, but as I found it
on the original I have put it in yours)

23

Departed on 18th Ranch at 5 PM on
the 13

Back on the line at Dec 13 14

- 1.57 To Luck Creek 4 hrs. 1 mi. 100 E.
- 41.00 Det. at post with 90 sec cor 1 made a mound of earth from a pit 4 ft 6.
- 41.30 To a Road at Am. Mts.
- 80.00 Det. at post with 90 sec Dec 11, 12, 13, 14 made a mound of earth, 4 ft 6.

West Hand on the line at Dec 11 14
Jan

- 57.25 To a Road at Am. Mts.
- 63.00 To Springs
- 79.96 Entance of Ran. Km 10 from of sec cor

East Comcha on the line at Dec 11 14
Jan

- 39.98 Det. at post at the 90 sec cor 1 made a mound of earth from a pit 4 ft 6.
- 79.96 To the post at the cor to Dec 11, 12, 13, 14

East Hand on the line at Dec 12 13
Jan

- 16.25 To a Road at Am. Mts.
- 71.45 To a Stream 4 hrs. 1 mi. 100 S. L. 6.
- 72.70 To a Stream 4 hrs. 1 mi. 100 S.
- 83.74 Entance of Ran. Km 10 from of sec cor.

West Comcha on the line at Dec 12 13
Jan

- 43.74 Det. at post with 90 sec cor 1 made a mound of earth from a pit 4 ft 6.
- 83.74 To the post at the cor to Dec 11, 12, 13, 14.

Wardship in 1801 Range No 3 & 4
Ch 115

Back On the Vine Feb Dec 11 & 12.

Jan

41.00 Put a post at the gr Dec 11 made a mound of earth from a pit 4 ch 6.

41.00 To a Road in range No 11.

61.00 To a Steam & the m d l u E. S. E.

80.00 Put a post at the Cor to Dec 12. 11 & 12 made a mound of earth from a pit 4 ch 5.

Wardship in the Vine Feb Dec 2 11.

Jan

1.60 To Road in range No 11.

45.25 To a Steam & the m d l u E. S. E.

79.80 Put a post at 10 ch of the Cor to 2. 3. 10 11

Wardship in the Vine Feb Dec 2 11

Jan

37.90 Put a post at the gr Dec 11 made a mound of earth from a pit 4 ch 6.

79.80 To the post at the Cor to Dec 1. 2. 11 & 12.

Wardship in the Vine Feb Dec 1 & 12

Jan

83.25 Put a post at the Cor 38 ch of the Vine

Wardship in the Vine Feb Dec 1 12

Jan

43.25 Put a post at the gr Dec 11 made a mound of earth from a pit 4 ch 6.

83.25 To the post at the Cor to Dec 1. 2. 11 & 12

Back On the Vine Feb Dec 1 & 12

Jan

41.00 Put a post at the gr Dec 11 made a mound of earth from a pit 4 ch 6.

25

Parish of St. James Dec 31 1871

79.82 Intersect of Boundary 875 26 1/2 off
Curtis Dec 31 1871 at a point in the
vicinity of an ancient iron pipe at S.

Mearns of the Mississippi
River in Parish of St. James & C.

Commence at second corner
on the East Boundary, thence down
the stream

In Dec 25

878.71 6.25
872.71 16.17
865.71 4.36

Point to the west of the
vicinity of the

In Parish

865.71 11.14
840.71 7.75
836.71 17.17
863.71 11.11
879.71 16.11
884.71 12.51

at the corner of the
Point of Rock Island by
Point of Rock Island by
Point of western by
to the west side of the

In Dec 31 1871

886.71 5.31
852.71 22.01
879.71 11.11
877.71 16.39

at the Ferry house
Head of Miller Island by
Head of Island by
at the point in line
at the corner of the
at the Head of Miller Island
Head of Miller Island by

In Dec 31

887.71 8.50

at 575 Swan C. the

Penetration to 18 of the range to 3 & 5 P.
Cinn 1845

945:11	11.11	
949:11	6.51	At 531 a stream 6th m. d.
954:11	17.11	Catastream.
933:11	6.50	At 435 stream 4th m. d.
919:11	15.00	Part of Millon Island by 40: 6
97-6	12.51	Part of 2nd Millon Island by 6.
956:11	20.22	To the point on Van Linn.
		By the era Vera by 857-6 49.86 c.
		Head of Island by 884-6

Meanders of Island in 34155. (See also)
Commencing at the intersection of the
line with sec 34155. starts near Island
on the North side at the an. cl. No.
Hence in Sec 34

986:11	5.00	
93-6	8.16	
West	8.23	
612-11	17.50	
643-11	23.00	
65-11	20.0	
17-6	0.24	
149-6	17.01	
148-6	12.01	
165-6	6.01	
170-6	10.30	
188-6	6.61	To the line by Sec 34 35 on the North side of the Island.

In Sec 35.

172-6	8.18	
170-11	5.35	
188-11	2.64	To the place of beginning.

27
B. 14
Meadures of the ...
Com. ...

Meadures of the ...
Commencing at the upper end of ...
at a point ... from meander
line on the South side of ... Island
Huna

126:11	1.50
144:11	2.00
158:11	1.00
162:11	2.50
153:11	5.00
160:11	12.00
141:11	10.00
179:11	7.50
128:6	1.00
131:6	2.50
139:6	2.50
146:6	11.50
148:6	1.50
133:6	3.00
161:6	8.00
166:6	6.00
170:6	5.25
178:6	16.00

Restoration of beginning,

Restoration of 640 acres ...
by Treaty of 1832, with the ...
claim of ...
Commencing at the ... Corner ...
atom mound on the ... bank of the ...
Mississippi River ...

189:6	14.50
171:6	29.00
183:6	41.00
173:6	5.45

No atom mound on the ...
of ...

Deming, No 18 Ranch 3 C 5
etc

Start

57.14 To a post from which

Mr Oak 10 mi in air by 923-98149 5

Work 80.00 ch to a mound in the prairie
Doubt 93.64 ch to the place of beginning.

Run at a bar of 8.20 C.

By Mr Gordon

54.70
49.60
14.70

Handwritten text at the top of the page, possibly a title or introductory sentence.

This is a page from a notebook.
 The handwriting is very faint and illegible.
 The page appears to be mostly blank with some ghosting of text.

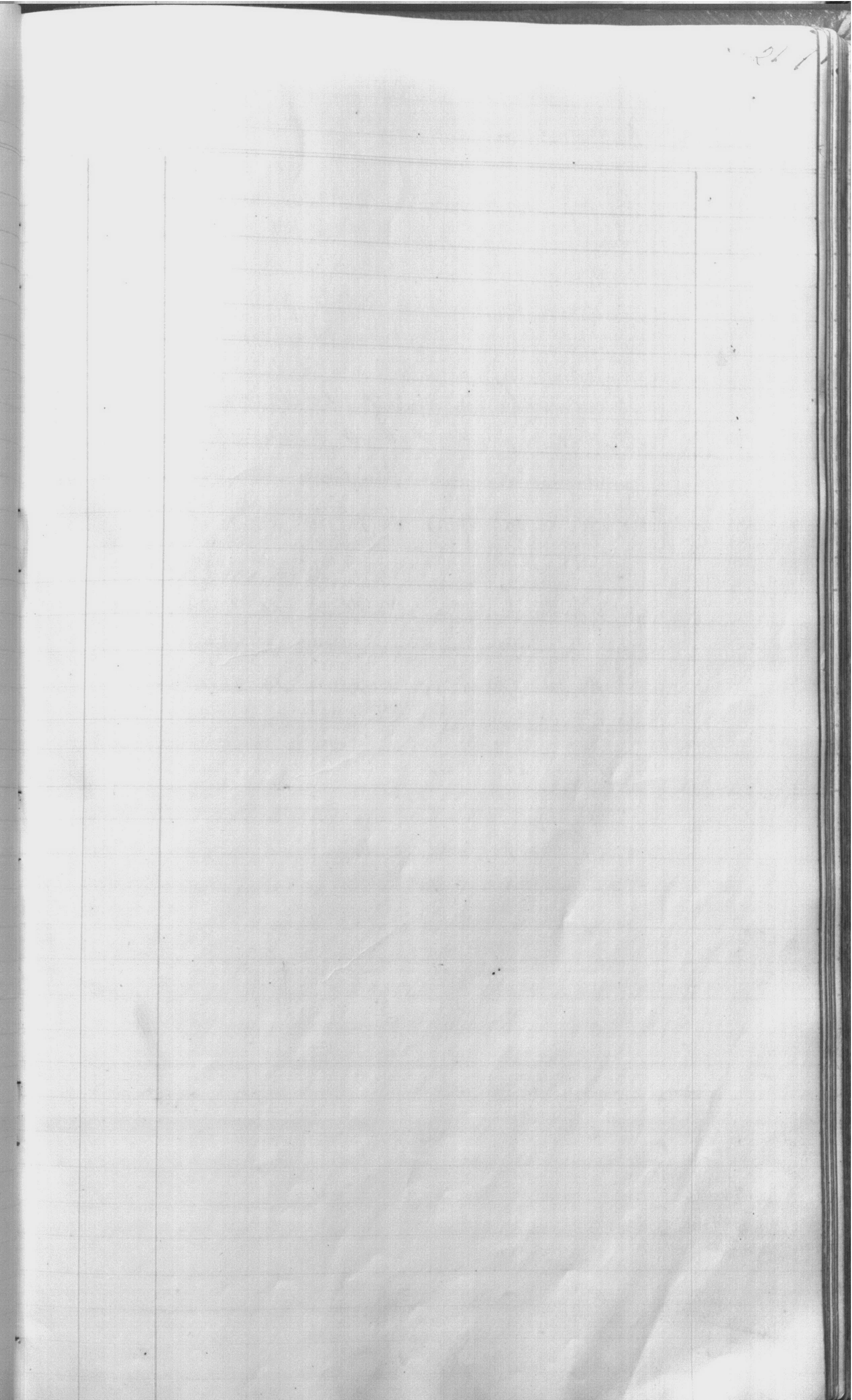

218

1. The first part of the paper is devoted to a general
 discussion of the problem. It is shown that the
 problem is equivalent to the problem of finding
 the minimum of a certain function. This is done
 by using the method of Lagrange multipliers.

x	y	z	w
1	1	1	1
2	2	2	2
3	3	3	3
4	4	4	4
5	5	5	5
6	6	6	6
7	7	7	7
8	8	8	8
9	9	9	9
10	10	10	10

The second part of the paper is devoted to a
 detailed analysis of the problem. It is shown
 that the minimum is attained at the point
 where all the variables are equal to 1. This is
 done by using the method of Lagrange multipliers.

Township 78 N. R. 3 E. of the Fifth

Principal Meridian, Commenced September 7, 1837

And Completed September 14, 1837* by Wm. A. Burt, D. S.

* Meanders of the Mississippi River excepted, which was done September 30, 1837.

South Between sections 34 and 35
00.25 Enter Marsh bearing W. N. W.
6.00 Leave Marsh
18.57 Intersect Mississippi River and set post

South Between sections 25 and 26
8.42 Intersect north line of Antoine LeClairs Reserved Section 26.47 from the N. W. corner thereof.
17.50 Road bears east.
65.00 Descend bank of the Mississippi
75.50 Foot of Ditto.

East Corrected between sections 26 and 35
40.00 Set quarter section corner and made mound.
54.70 Intersect Antoine LeClairs Reserved section 21.30 from the S. W. corner on the Mississippi River, set post and made mound.

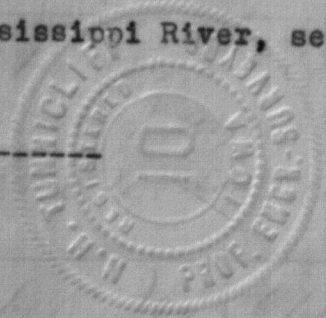

4000 Set a post for the q. sec. cor. made a mound of earth from a post 4000.
54.70 Intersect Antoine LeClairs Reserved Sec. 21.30 from the S. W. corner on the Mississippi River, set a post on the river, reach from a post 4000.

21
Deanship of the Mississippi River

Sub on the Vine Feb Dec 14 015

Survey of Township 28 N. R. 3 E. of the Fifth
Principal Meridian, Commenced September 7, 1837
and Completed September 14, 1837 by W. A. East, D. S.

* Meanders of the Mississippi River
excused, which was done September
30, 1837.

Between sections 24 and 25
Enter Marsh bearing N. W. W.
Leave Marsh
Intersect Mississippi River and set post

Between sections 26 and 27
Intersect north line of Antoine LeGlat's Reserved Sec-
tion 26.47 from the S. E. corner thereof.
Road bears east.
Descend bank of the Mississippi
Foot of Hill.

Corrected between sections 28 and 29
Set quarter section corner and made mound.
Intersect Antoine LeGlat's Reserved section 28 from
the S. W. corner on the Mississippi River, set post
and made mound.

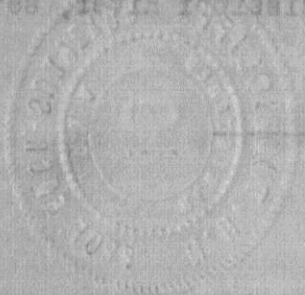

West of and on the Vine NW Sec 28 110
100

4.75 East Road is N. M.
5000 Antoinette M. M. 25 M. 2000

211

Meanders of the Mississippi River, Commencing at The
Meander Post in East Boundary

Thence down stream on right Bank of Said River

In Section 25

S 78½ W	6.25	
S 72½ W	16.00	
S 65 W	4.36	To East line of Antoine LeClairs Reserve
S 65 W	10.14	
S 40½ W	7.75	A. LeClairs house 9 Ch. from River.
		Foot of Rock Island bears S 8° 45' W.
S 56½ W	17.00	Foot of Rock Island bears S 21 E. 25.36 Ch.
S 63¼ W	10.00	Object over River* bears S 17° 35' E. 53.30 Ch.
S 79¾ W	16.00	Same object over River bears S 33° 35' E.
S 88¼ W	<u>12.50</u>	To W. line of Antoine LeClairs Reserve
	100.00	

* This object is 17.50 Ch. N. of a corner said by the inhabitants to be the corner of sections 25 - 26 - 35 - 36. No mound or bearings, this corner doubtful.

In Section 35 and town of Davenport

S 86½ W	5.50	At 5.00 Ferry house 50 links from River
N 85¾ W	22.00	
N 79¾ W	11.00	Head of a Willow Island bears S 52¾ W.
		Head of 2 ^d Willow Island bears S 43½ W.
N 87½ W	16.39	To point in line between sections 34 and 35.
		At 7.50 head of Willow* Island bears S 31½ E.
		At 9.08 leave Davenport and enter timber.
		* Head of 2 ^d Willow Island bears S 32¼ W.

In Section 34

S 81 W	8.50	At 5.75 stream 6 links.
S 75¾ W	11.00	
S 69½ W	6.50	At 5.50 stream 6 links
S 54 W	17.00	Enter prairie.
S 33 W	6.50	At 4.35 stream 3 links.
S 19 W	15.00	Foot of Willow Island bears S 46½ E.



2877 8.50 At 5.75 stream 6 links.

mouth of the Mississippi River, commencing at the
marker post in East Boundary
Thence down stream on right bank of said river

In Section 35

8.35 W 78 1/2
18.00 W 78 1/2
4.35 W 85
10.14 W 85
7.75 W 40 1/2
A. LeGiz's house & Ch. from River.
Foot of Rock Island bears S 80 45' W.
Foot of Rock Island bears E 81 21' S 28.38 on.
Object over river bears S 170 35' E. 23.30
OL.
Same object over river bears S 350 35' E.
To W. line of Antoinette LeGiz's Reserve
100.00
This object is 17.50 Ch. N. of a corner said by
inhabitants to be the corner of sections 35 - 35 - 35
No mound or bearing, this corner doubtful.

In Section 35 and town of Davenport

8.50 W 85
23.00 W 85
11.00 W 85
Head of Willow Island bears S 82 1/2 W.
Head of Willow Island bears S 45 W.
At 9.08 leave Davenport and enter timber.
At 9.50 head of Willow Island bears S 84 1/2 W.

In Section 34

8.50 At 8.50 stream & links.
11.00
8.50 At 8.50 stream & links
17.00
8.50 At 8.50 stream & links.
18.00 Foot of Willow Island bears S 84 1/2 W.



211

S 7 E 12.50* Foot of 2^d Willow Island bears East.
At 5.00 foot of Willow Island bears N 73 $\frac{1}{2}$ E.
Foot of 2^d Willow Island S 55 $\frac{1}{2}$ E.

* An object on left bank of River bears
S 33 $\frac{1}{4}$ E.

* Head of Island bears S 4 $\frac{1}{2}$ E.

S 50 $\frac{1}{2}$ W 20.22 To post in Range Line.
97.22 Object over River bears S 57 E 49.86 Ch.
Head of Island S 58 $\frac{1}{2}$ E.

General Remarks for T. 78 N. R. 3 E. Fifth Meridian

In the survey of this township it will be seen that I have varied from the plan recommended in my special instructions for the survey thereof, by making fractional sections on the East boundary of this township. This I did because I believed that if the Surveyor General had known that this township was 5.09 Ch. over Six miles in closing out between sections 24 and 25 he would have recommended the course I have pursued. But if the Surveyor General does not approve of my making fractional sections on the East boundary of this township I wish this field book returned to me immediately and I will make a resurvey in the manner recommended. It will be further observed that I have closed farther west of post on north boundary than would be expected. The reason of it I hope to find when I survey T. 78 N. R. 3 E.

This township (The Mississippi Bottom excepted) is high rolling land 2^d and good rate, has some timber on the bottom and generally timbered thinly along the bluffs, the streams are generally quick and have good water. Davenport is pleasantly situated at the foot of the Rapids on sections 35 and 36. It has 3 stores, one grocery and a Tavern. Here is a good landing for steam boats at any stage of water.

Wm. A. Burt, D. S.

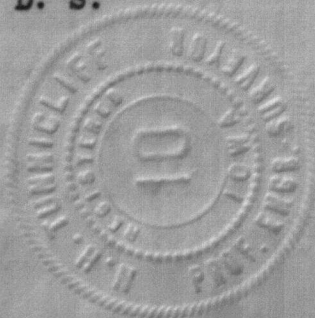

2877 8.50 11 575 Stuart C. Co. Ind.

Foot of 2d Willow Island bears N 78° E
 as 2.00 foot of Willow Island bears N 78° E
 Foot of 2d Willow Island 25 1/2 ft
 * An object on left bank of River bears
 S 23 1/2° E
 * Head of Island bears S 4 1/2° E
 To post in Range line. 29.33
 Object over River bears S 27 E 48.88 Ga. 27.33
 Head of Island S 88 1/2° E.

General Remarks for T. 78 N. R. 3 E. Fifth Meridian

In the survey of this township it will be seen that I have varied from the plan recommended in my special instructions for the survey thereof, by making fractional sections on the East boundary of this township. This I did because I believed that if the Surveyor General had known that the town-

- 10 -

ships 24 and 25 be would have recommended the course I have pursued. But if the Surveyor General does not approve of my making fractional sections on the East boundary of this township I wish this field book returned to me immediately and I will make a resurvey in the manner recommended. It will be further observed that I have closed farther west of post on north boundary than would be expected. The reason of it I

done to find when I survey T. 78 N. R. 3 E. This township (The Miscellaneous Boston excepted) is high rolling land 2d and good water, has some timber on the bottom and generally timbered thinly along the flats, the streams are generally Dutch and have good water. Government is pleasantly situated at the foot of the Falls on sections 22 and 23. It has 2 stores, one grocery and a Tavern. There is a good landing for steam boats at any stage of water.

Wm. A. Burr, D. S.



Survey of the 18th & 19th Twp. of Range 3 East of 5th P.M.

*Meanders of an Island in Sec 34
(Commencing at the upper end of the island)*

Twp. 78 North of Range 3 East of 5th P.M.
(Note: Begin at N.E. Cor. 34-78-3)

- South Between Sections 34 and 35.
- 22.74 Over Slew and set a post.
- 27.95 To River and set a post.

Meanders of an Island in Sections 34 and 35 Claimed by
James Hall of Davenport

Begin on North side, thence down stream in section

34.

- S 86 W 5.00
- S 3 E 2.16
- West 8.33
- S 72 W 17.50
- 32.89
- S 43 W 23.00
- S 5 W 5.00
- S 17½ E 2.34
- N 49 E 17.00
- N 48 E 13.00
- N 65 E 6.00
- N 70 E 10.50
- N 88 E 6.60

{Sept. 7th, 1842
{This Island is very near valueless.
{The wood is all out off and it is
{rather low but Mr. Hall claims it
{and will probably buy it.
J. E. Whitther, Dep. Surveyor }

To line of sections 34 and 35.

In Section 35

- N 72 E 8.18
- N 70 W 5.35
- N 88 W 2.64 To place of beginning
- 99.51

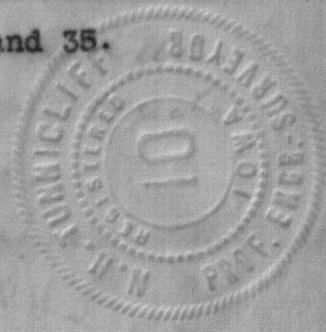

1872-6 14.50
1871-6 29.00
1853-6 41.00
1873-6 5.45

*To Stone mound on the S.E. corner
of Iowa reserve. Stone*

Memphis to St. Louis & St. Paul
Cinn. 1885

1875 11.11
1891 6.51 (11 51 a steam. 6th Dec.)
1891 11.11

Typ. 78 North of Range 3 East of 25th P.M.
(Note: Begin at N.E. Cor. 34-78-3)

Between sections 34 and 35.
Over 21/2 and set a post.
To river and set a post.
Meanders of an island in sections 34 and 35 claimed by
James Hall of Bavenport
Begin on North side, thence down stream in section

3.00	W
2.15	E
2.25	E
11.30	W
23.20	E
23.00	W
8.00	W
3.25	E
12.00	E
12.00	E
8.00	E
10.50	E
8.50	E
2.15	E
7.25	W
1.24	W
22.21	W

(Seal. 7th, 1885)
This island is very near valueless.
The wood is all cut off and it is
rather low but Mr. Hall claims it
and will probably pay it.
J. E. Whitaker, Dep. Surveyor



To line of sections 34 and 35
In section 35

To place of beginning

1875 11.11
1881 2.64 To the place of beginning