

Index Diagram to Dunsheep 790s  
 Range No 2858 Area

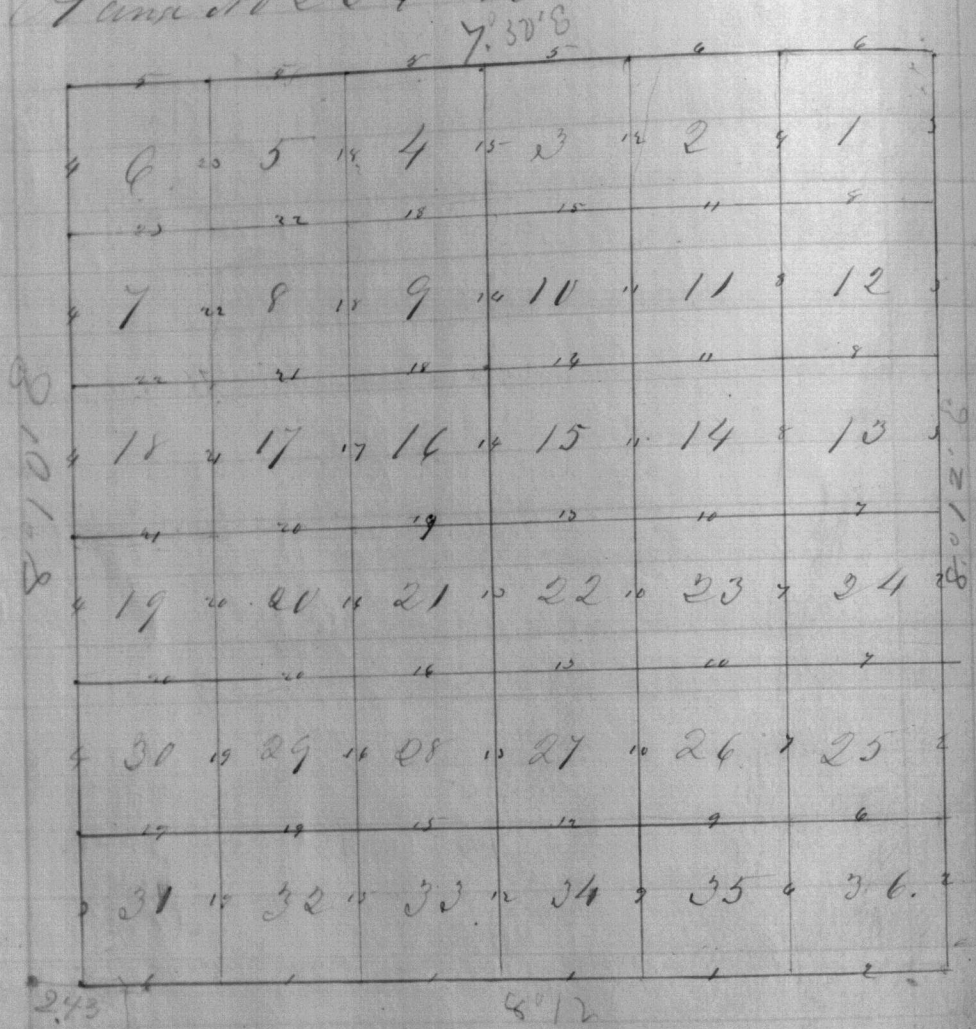



1  
D. ... Ches

French Boundary

East On the South Side of Dec 31  
 42.00 Put a post at the ...  
 a mound of earth from a post 4th 6  
 47.50 Put a post at the ...  
 82.00 Put a post at the ...  
 made a mound from a post 4th 5.

East On the South Side of Dec 32  
 41.00 Put a post at the ...  
 a mound of earth from a post 4th 6  
 81.00 Put a post at the ...  
 made a mound from a post 4th 5.

East On the ... Dec 33  
 33.00 ...  
 40.00 Put a post at the ...  
 mound of earth from a post 4th 6  
 80.00 Put a post at the ...  
 made a mound of earth ...

East On the South Side of Dec 34  
 41.00 Put a post at the ...  
 mound of earth from a post 4th 6  
 81.00 Put a post at the ...  
 made a mound of earth ...

East On the South Side of Dec 35  
 28.00 ...



Quinn's No 79 Mine at 26 S & 10 E  
 Dec 15

4000 Det a post at the gr see cor made  
 a mound from a pit 4 th E.  
 5000 Det a post at the cor to Sec 35 13 65  
 made a mound of earth pit 4 th S.

Look on the South Side of Dec 36  
 Jan 8 1866

4000 Det a post at the gr see cor made  
 a mound of earth pit 4 th E.  
 5000 Det a post for the Cor to Sec 7 8 79  
 at corner 20 E made a mound  
 of earth from a pit 4 th S.

East Boundary.

Look on the East Side of Dec 36  
 Jan 8 1866

4000 Det a post at the gr see cor made  
 a mound of earth from a pit 4 th E  
 4000 Det a post to the NW corner.  
 5000 Det a post at the cor to Sec 25 13 65  
 made a mound from a pit 4 th S.

Look on the East Side of Dec 25,  
 Jan 8 1866

4000 Det a post for the gr see cor made  
 a mound of earth from a pit 4 th E.  
 4950 Det a post to the NW corner NW.  
 5000 Det a post at the cor to Sec 24 12 25  
 made a mound from a pit 20 th S.

Look on the South Side Dec 24  
 Jan 8 1866

4000 Det a post at the gr see cor made  
 a mound of earth Pit 4 th E



Parish of St. Andrew's 19th Nov 1847

31.01 Put a post at the 90 Dec 1847  
made a mound of earth 4th S.

North On the East side of Dec 18  
Jan 1848

36.00 Put a post at the 90 Dec 1847  
46.00 Put a post at the 90 Dec 1847 made  
a mound of earth from a pit 4th S.  
87.00 Put a post at the 90 Dec 1847  
made a mound of earth 4th S.

North On the East side of Dec 18  
Jan 1848

40.00 Put a post at the 90 Dec 1847 made  
a mound of earth from a pit 4th S.  
80.00 Put a post at the 90 Dec 1847  
made a mound from a pit 4th S.

North On the East side of Dec 18  
Jan 1848

40.00 Put a post at the 90 Dec 1847 made  
a mound of earth from a pit 4th S.  
79.78 Put a post at the 90 Dec 1847  
made a mound of earth 4th S.

West Boundary

North On the East side Dec 36 19 R 1 E  
Jan 1848

40.00 Put a post at the 90 Dec 1847 made a  
mound of earth from a pit 4th S.  
80.00 Put a post at the 90 Dec 1847  
made a mound of earth 4th S.



Quadrup No 79 Camp No 2 East of the  
Chert

North on the East side of Dec 23  
Jan 876

4000 Det a part at the gr Dec cor made a  
mound of Chert from a pit 4 th E.

8000 Det a part at the cor to Dec 24 1257  
made a mound of Chert Pit 4 th S.

North on the East side of Dec 24  
Jan 8006

4000 Det a part at the gr Dec cor made a  
mound of Chert from a pit 4 th E.

8000 Det a part at the cor to Dec 10 + 247  
made a mound of Chert Pit 4 th S.

North on the East side of Dec 13.  
Jan 7557

3700 Found a trail to the S.

4000 Det a part at the gr Dec cor made a mound  
of Chert from a pit 4 th E.

7700 Det a part to the S E.

8000 Det a part at the cor to Dec 12 131  
made a mound of Chert Pit 4 th S.

North on the East side of Dec 12  
Jan 7456

4000 Det a part at the gr Dec cor made a  
mound from a pit 4 th E.

8000 Det a part at the cor to Dec 10 127  
made a mound from a pit 4 th S.

North on the East side of Dec 116  
Jan 7406

2800 Det a part 25 th in a run N.

4000 Det a part at the gr Dec cor made



5  
Dunstable No 79th Run 11 22 57 on Com  
Chas

a mound of earth from a pit 4 4th  
8000 Det a post at the Cor to Dunstable 191  
8000 Det a post at the Cor to Dunstable 191  
made a mound of earth from a pit 4 4th

North Boundary.

East On the North Side of Dec 31. 1801  
Jan 1806

41.35 Det a post at the grade cor made  
a mound of earth from a pit 4 4th  
45.33 Det a post 25 1/2 m m m m m  
7000 Det a post 20 1/2 m m m m m  
81.35 Det a post at the grade Dec 31 1802  
made a mound of earth pit 4 4th

East On the North Side Dec 31  
Jan 1806

4000 Det a post at the grade cor made  
a mound of earth pit 4 4th  
58.50 Det a post 15 m m m m m  
8000 Det a post at the Cor to Dec 31 1803  
made a mound from a pit 4 4th

East On the North Side of Dec 31.  
Jan 1806

8000 Det a post at the grade cor made  
a mound of earth from a pit 4 4th  
42.50 Det a post 15 m m m m m  
8000 Det a post at the Cor to Dec 31 1804  
made a mound from a pit 4 4th.

41.78  
41.35  
8313  
41.56  
41.78  
8334  
41.67

East On the North Side Dec 1804  
Jan 1806

4000 Det a post at the grade cor made



6  
Downship N 79° W Range No 26 S 4th Tada  
Dec 1855

a mound of earth. Pit 4th S.  
8177 Put a post at the Cor to Dec 341357  
made a mound of earth No 4th S.

East On the South side of Dec 35  
Nov 8158

4100 Put a post at the gr Dec cor made  
a mound of earth from a pit 4th S.  
8177 Put a post at the Cor to Dec 35136  
made a mound from a pit 4th S.

East On the South side of Dec 36  
Nov 8206

4100 Put a post at the gr Dec cor made  
a mound of earth from a pit 4th S.  
8177 Entered Range Line 22th Tappan  
Put a post at the Cor to Downship  
791805. Kansas 2136 made a  
mound of earth Pit 4th S.

Subdivision

West On the Line No Dec 35136  
Nov

4100 Put a post at the gr Dec cor made  
a mound of earth from a pit 4th S.  
8177 Put a post at the Cor to Dec 25.26.35136  
made a mound of earth. Pit 4th S.

East Tension on the Line Dec 25136  
Nov

8020 Entered Range Line 6th S of Dec cor

West Tension on the Line Dec 25136  
Nov



7

Sancti Spiritu 79. D. K. ...

40.10 Det a post at the ...  
a mound of earth from a pit 4th G.  
80.20 Det a post with ...

North On the Line Feb Dec 25 26

40.10 Det a post at the ...  
a mound of earth from a pit 4th G.  
80.20 Det a post with the ...  
made a mound of earth Feb 4th S.

East Tandon on the Line Dec 24 25

80.20 Det a post ...

West Conecta on the Line Dec 24 25

40.10 Det a post at the ...  
mound of earth from a pit 4th G.  
80.20 Det a post at the ...

West On the Line Feb Dec 23 24

40.10 Det a post at the ...  
a mound of earth Feb 4th G.  
80.20 Det a post with the ...  
made a mound from a pit 4th S.

East Tandon on the Line Feb Dec 13 24

37.25 Det a post ...  
80.20 Det a post ...

West Conecta on the Line Feb Dec 13 24



8  
Dismal Swamp Range No 2 & 5  
Chad

4000 Det a spot at the gr Bee cor made  
a mound of earth from a pit 4th E.  
8004 Det a spot at the Cor to Dec 13, 14, 23 & 24.

South on the Lim Feb Dec 13 & 14  
Nov

4000 Det a spot at the gr Bee cor made a  
mound of earth from a pit 4th E.  
8000 Det a spot at the Cor to Dec 11, 12, 13 & 14  
made a mound of earth pit 4th S.

East Randon on the Lim W Dec 12 & 13  
Nov

1100 Det a Road to W.  
8000 Det a spot Range Lim 32 ch of Dec ca

West Concha on the Lim W Dec 12 & 13  
Nov

4000 Det a spot at the gr Bee cor made  
a mound of earth from a pit 4th E  
8000 Det a spot at the cor to Dec 11, 12, 13 & 14.

South on the Lim Feb Dec 11 & 12  
Nov

1300 Det a Road to W. W.  
4000 Det a spot at the gr Bee cor made  
a mound of earth from a pit 4th E  
6000 Det a small Gracke 150 ch W of Lim.  
6500 Enter a Prairie to W. S.  
7000 Enter a Prairie to W. S.  
8000 Det a spot at the Cor to Dec 1, 2, 11 & 12  
made a mound of earth Pit 4th S

East Randon on the Lim W Dec 10 & 11  
Nov



Danmarksholm 19th Regt Camp at 2 1/2 miles  
Feb 11

5.11 at Small Green 150 lbs of Lime.  
9.06 at Small Green 150 lbs of Lime.  
8000 Entrance of Range den 14 lbs of Lime

West Concha on the Lim det Dec 1 12  
Jan -

4100 Det a part at the 90 sec cor made  
a mound of Earth from a pit 4th 6.  
8000 Det the part at the Cor Dec 2 11 12.

West Concha Lim det Dec 1 12  
Jan -

4000 Det a part at the 90 sec cor made  
mound of Earth from a pit 4th 6.  
7905 Entrance of Range at Cor Dec 1 12.

West Concha Lim det Dec 3 13 35  
Jan -

11.10 Det a part at the 90 sec cor made  
mound of Earth from a pit 4th 6.  
8150 Det a part at the Cor Dec 26 27 34 35  
made a mound of Earth from pit 4th 5.

East Randorn on the Lim det Dec 26 35  
Jan -

79.88 Entrance of Range Lim 32 lbs of Cor (Hub)

West Concha on the Lim det Dec 26 35  
Jan -

39.94 Det a part at the Cor made  
mound of Earth from a pit 4th 6.  
79.88 Det the part at the Cor Dec 26 27 34 35.



Parish of St. Andrew's in the Parish of St. Andrew's  
Ch. 13

Mark on the Line Feb Dec 22 & 27

Jan -

- 4000 Put a post at the gr Dec cor made a mound of earth from a post 4 lb 6.
- 8000 Put a post at the Cor to Dec 22. 23. 26 & 27 made a mound of earth from 4 lb 5.

East Pandemon on the Line Oct Dec 23 & 26

Jan:

- 2000 Interest of St Andrew 10 lb of Dec cor

West Comedia on the Line Oct Dec 23 & 26

Jan -

- 4000 Put a post at the gr Dec cor made a mound of earth from 4 lb 6.
- 8000 Put a post at the Cor to Dec 22. 23. 26 & 27

Mark on the Line Feb Dec 22 & 27

Jan

- 2450 Level a mark W. S. W.
- 3150 Level the mark W. S. W.
- 4000 Put a post at the gr Dec cor made a mound of earth from a post 4 lb 6.
- 8000 Put a post at the Cor to Dec 24. 15. 22 & 27 made a mound of earth from 4 lb 5.

East Pandemon on the Line Oct Dec 14 & 23

Jan

- 4700 Post Road is W. S. W.
- 7954 Interest of St Andrew 25 lb of Dec cor

West Comedia on the Line Oct Dec 14 & 23

Jan

- 8972 Put a post at the gr Dec cor made a



Journal of 1879 at Rome Dec 6 5 1/2 hrs. near  
the 15.

made a mound of earth from a pit 4th 6.  
79.94 Put a post at the Cor. Dec 14 15. 22 125.

Work on the line bet Dec 14 15

36.75 On a Road to W. D.

40.00 Put a post at the gr Dec cor. made a mound of earth from a pit 4th 6.

56.40 To a stream 14 1/2 m. south of same 2. 11.

80.00 Put a post at the Cor. Dec 10. 11. 14 15. made a mound of earth from a pit 4th 6.

East Pandemon on the line bet Dec 9 11 14

79.90 Entered N.W. line 12. 1/2 of sec. cor.

West Concordia on the line bet Dec 11 14

39.95 Put a post at the gr Dec cor. made a mound of earth from a pit 4th 6.

79.90 Put a post at the Cor. Dec 10. 11. 14 15.

Work on the line bet Dec 10 11.

40.00 Put a post at the gr Dec cor. made a mound of earth from a pit 4th 6.

80.00 Put a post at the Cor. Dec 2. 3. 10 11 14 made a mound of earth from a pit 4th 6.

East Pandemon on the line bet Dec 2 11

40.00 On a Road to W. D.

75.00 On small Grove 4 1/2 hrs.

79.75 Entered N.W. line 12. 1/2 of sec. cor.



Departure No 19, Range No 6 S P M.  
Feb 13

West Canada on the Vini lot Dec 27 11  
Nov

39.875 Depa part at the gr sea cor made a mound of earth from a pit 4 lbs E.  
79.75 Vetter part at the Cor to Dec 2 3.10 11.

South Can the Vini lot Dec 2 13  
Nov

22.00 Vetter in Grove to the M.  
30.00 Vetter at Grove to the M.  
41.00 Depa part at the gr sea cor made a mound of earth from a pit 4 lbs E.  
68.00 Depa Road to the M.  
79.00 Entered at Body at Cor to Dec 2 13.

South Canada Vini lot Dec 33 14  
Nov

41.00 Depa part at the gr sea cor made a mound of earth. Feb 4 lbs E.  
80.00 Depa part at the Cor to Dec 27. 28. 33 14  
made a mound of earth Feb 4 lbs.

East Pandora on the Vini lot Dec 27 14  
Nov

65.00 Depa Road to the M.  
79.95 Entered at Vini 20th of Dec 11

West Canada on the Vini lot Dec 27 14  
Nov

39.975 Depa part at the gr sea cor made a mound of earth Feb 4 lbs E.  
79.95 Vetter part at the Cor to Dec 27. 28. 33 14



Membership No 1905 Panam 22 & 23rd Dec  
Cross

Such on the 21st Dec 27129

Pan

40.00 Put a post at the grade cor 1 made a mound of earth from a pit 4 lb 6

90.00 Put a post at the cor 2 Dec 21 22 27128, made a mound of earth pit 4 lb 5.

East Panam on the 21st Dec 22127

Pan

14.50 Put a post at the 1st M.

80.10 Put a post at the 2nd M. at the sec cor

West Panam on the 21st Dec 22127

Pan

40.05 Put a post at the grade cor 1 made a mound of earth from a pit 4 lb 6

80.10 Put a post at the cor 2 Dec 21 22 27128

Such on the 21st Dec 21 22

Pan

18.30 Put a post at the 1st M.

40.00 Put a post at the grade cor 1 made a mound of earth from a pit 4 lb 6

75.00 Put a mark at the 2nd M.

79.50 Put a mark at the 3rd M.

80.00 Put a post at the cor 2 Dec 21 22 27128 made a mound of earth from a pit 4 lb 5.

East Panam on the 21st Dec 15.12.2

Pan

1.00 Enter a mark at the 1st M.

39.00 Put a mark at the 2nd M.

79.90 Put a post at the 19th S of sec cor



Drainage of the Range 112 & 113 on down  
the side

West Concha on the Line Vol Dec 15722  
Jan.

- 37.99 Detaput at the g. d. e. cor made a mound of earth from a pit 4 lb C.
- 79.92 To the post at the Cor to Dec 15. 16. 21. 22.

South Concha Line Vol Dec 15714  
Jan 1477

- 40.00 Detaput at the g. d. e. cor made a mound of earth from a pit 4 lb C.
- 46.00 To a road it runs N. W.
- 57.00 Under a Hickory Grove it runs N.
- 58.90 To a 10 oak 22 mi in dia.
- 67.75 To an Elm 12 mi in dia.
- 81.00 Detaput at the Cor to Dec 9. 10. 15. 16  
To a Oak 20 mi in dia. Dec 6 104  
To an Elm 20 mi in dia. Dec 4 109.

East Concha on the Line Vol Dec 10+15  
Jan

- 5.75 To a line N 25 lb made it runs N. W.
- 7.37 To the same line 25 lb made it runs S. W.
- 12.00 Under a Spruce it runs N. W.
- 15.92 To a line N 25 lb made it runs N. W.
- 57.10 To the post at the Cor to Dec 9.

West Concha on the Line Vol Dec 10+15  
Jan

- 40.05 Detaput at the g. d. e. cor made a mound of earth from a pit 4 lb C.
- 57.10 To the post at the Cor to Dec 9. 10. 15. 16.

South Concha Line Vol Dec 9+10  
Jan



Dumfries to 79th Range at 2 1/2 5th. Cor  
Chad's

- 1.00 To a creek 25 lbs made up run 11.1.11.
- 12.00 To a 17 Cal 10 mi in dia.
- 20.70 To a 12 Cal 20 mi in dia.
- 24.00 Under a spruce up to 6th.
- 40.00 Put a post at the grade cor made a mound of earth from a pit 4 lb 6.
- 80.00 Put a post at the Cor to Sec 34.9 11.11
- made a mound of earth 1/2 4 lb 3.

East Pandon on the line bet Sec 3 11

80.00 Intersect 1st line 5 lbs 1/2 of the sec cor

West Concord on the line bet Sec 3 11

- 40.00 Put a post at the grade cor made a mound of earth from a pit 4 lb 6.
- 80.00 Put a post at the Cor to Sec 3.4.9 11.

North Concord on the line bet Sec 3 11

- 40.00 Put a post at the grade cor made a mound of earth from a pit 4 lb 6.
- 79.00 Intersect 1st dy at the cor Sec 3 11.

North Concord on the line bet Sec 32 33

- 40.00 Put a post at the grade cor made a mound of earth from a pit 4 lb 6.
- 80.00 Put a post at the Cor to Sec 28.29 32 33
- made a mound of earth 1/2 4 lb 8.

East Pandon on the line bet Sec 25 33

Cor.



Parish of St. Paul's  
19.15

23.80 To all roads in the parish  
24.71 To a Steam 3/4 lb iron in the new St.  
79.80 Contained in the same sheet of the Dec. cor.

West Comed on the same Dec 28 1833  
1000

39.90 To a part of the gr Dec cor made  
a mound of earth from a pit 4th Co  
79.80 To the part of the Cor Dec 28. 29. 30. 31.

North Com on the same Dec 29  
1000

41.00 To a part of the gr Dec cor made  
a mound of earth from a pit 4th Co  
81.00 To a part of the Cor Dec 20. 21. 22. 23.  
made a mound of earth Pit 4th Co.

East Com on the same Dec 21 1835  
1000

12.10 To all roads in the parish  
24.30 To a Steam 3/4 lb iron in the new St.  
57.50 To a Steam 3/4 lb iron in the new St.  
79.74 Contained in the same sheet of the Dec. cor.

West Com on the same Dec 21 1838  
1000

39.81 To a part of the gr Dec cor made a  
mound of earth Pit 4th Co.  
79.74 To the part of the Cor Dec 20. 21. 22. 23.

North Com on the same Dec 20 1821  
1000

18.10 To a Spring outlet 3/4 lb iron in the new St.  
20.00 To a part of the gr Dec cor made a



Partnership No 79 of Stumpole 28 5 PM  
Chas

measured of Earth from a pit 4 lb 6.

84.00 Put a part at the Cor. to Dec 16 1851 20 1851

made a mound of Earth 4 lb 5.

Went to London on the Ven 14 Dec 1851

1.40

5.00 To a Pond in sum. B.

10.15 To a Stream with side of sum. B. and  
and Enter Dimple in sum. B.

15.00 Enter a Prairie in sum. B.

39.00 Enter a marsh in sum. B.

41.00 To a Pond in sum. B.

44.00 To a Stream 2 lbs in sum. B.

78.00 Leave the marsh in sum. B.

80.00 Entered at St. Louis at Cor.

Went to London on the Ven 16 Dec 1851

1.40

40.00 Put a part at the Cor. to Dec 16 1851 made a  
mound of Earth from a pit 4 lb 6.

80.00 To the part at the Cor. to Dec 16 1851.

Went on the Ven 16 Dec 1851

1.40

21.90 To a Stream in sum. B.

22.00 Enter Dimple in sum. B.

33.37 Enter Prairie in sum. B.

40.00 Put a part at the Cor. to Dec 16 1851 made a  
mound of Earth from a pit 4 lb 6.

36.75 Enter a field.

65.00 Leave the field.

72.50 Enter Hickory Grove in sum. B.

80.00 Put a part at the Cor. to Dec 16 1851

A R. 14 in in dia to 1336 38

An. 15 in in dia to 270 10 2.



Manuscript to 19. Wampsted & F. H. L. ...  
Ch. 13

Cart Pandon on the Vine Feb 9 16  
Van

39.11 Cart Road is No. 13.  
39.17 Cart Road 41 lbs 1/2 the Cor to 9. 10. 15 116

West Corched on the Vine Feb Dec 9 116  
Van

39.21 Toat Road 41m 10 m in de.  
40.00 Wasaprot at the gr dec cor 1 m a d a  
at 11 Oak 20 m de a light 3 1/2 W 24.  
at 12 Oak 22 m de a 5 1/2 W 39.  
39.17 Toat Road at the Cor to Dec 8. 9. 16 117

Cart on the Vine Feb Dec 5 9  
Van

15.51 Toat Road 20 lbs m a is 2 ans 13.  
20.00 Cart a Prana is No. 12.  
40.01 Wasaprot at the gr dec cor 1 m a d a  
a mound of Couch from a pit 4 lb 6.  
39.17 Toat Road at the Cor to Dec 5. 8. 9. 11  
m a d a mound of Couch pit 4 lb 5.

Cart Pandon on the Vine Feb Dec 4 9  
Van

41.51 Toat Road is No. 16.  
38.04 Cart Road 12 lbs 1/2 the Sep the Dec cor.

West Corched on the Vine Feb Dec 4 9  
Van

40.12 Wasaprot at the gr dec cor 1 m a d a  
mound of Couch from a pit 4 lb 6.  
38.04 Toat Road at the Cor to Dec 4. 5. 8. 9.

Cart on the Vine Feb Dec 4 5  
Van



Municipal 79. D. H. ...

4.000 Desapunt at the ... made a mound of earth from a pit 4th 6. 19.00 ...

Went on the ... Dec 31 1932

4.000 Desapunt at the ... made a mound of earth from a pit 4th 6. 8.00 Desapunt at the ... made a mound of earth from a pit 4th 6.

East Pandem on the ... Dec 29 1932

19.86 ...

Went on the ... Dec 29 1932

39.93 Desapunt at the ... made a mound of earth from a pit 4th 6. 19.86 ...

Went on the ... Dec 31 1931

81.86 ...

Went on the ... Dec 31 1931

41.86 Desapunt at the ... made a mound of earth from a pit 4th 6. 81.86 ...

Went on the ... Dec 29 1930

40.11 Desapunt at the ... made a



Partnership in 19th St King ch 265 P.M. Co  
Ch 13

amount of Cash from a July 4th C.  
89.00 Put a part of the cash Dec 19. 21. 29. 01  
made a mound of earth Feb 4th S.

East Tandon on the Vine bet Dec 9 20 29  
100

79.90 Put a part of the Vine 33 & R. of the cor.

West Connected on the Vine bet Dec 20 29  
100

89.95 Put a part at the gr Dec cor made a  
mound of earth from a July 4th C.

79.90 Put a part at the Cor to Dec 19. 21. 29. 01.

West Tandon on the Vine bet Dec 9 19 30  
100

81.74 Put a part of Tandon Vine 3 the 2 of Dec cor.

East Connected on the Vine bet Dec 9 19 30  
100

81.74 Put a part at the gr Dec cor made a  
mound of earth from a July 4th C.

81.74 Put a part at the Cor to Dec 9 19. 21. 29. 01

West Cor on the Vine bet Dec 19 20  
100

40.00 Put a part at the gr Dec cor made a  
mound of earth from a July 4th C.

80.00 Put a part at the Cor to Dec 17. 19. 19 20  
made a mound of earth Feb 4th S.

East Tandon on the Vine bet Dec 17 20  
100

120.00 Small Grove 300 the S. of the Vine



Members of the 1st & 2nd Regiments of the 1st Inf. in the  
Ches.

40.00 Small Iron 400 lb of the same  
79.98 Entered at the same at parts.

West Cometa on the 1st Dec 1819  
100

39.99 Put a part at the grade cor made a  
mound of earth from a pit 4 lb 6.

79.98 Put the part at the Cor Dec 17. 18. 19. 20.

West Pandom on the 1st Dec 1819

81.64 Entered at the same 4 lb of Dec cor.

East Cometa on the 1st Dec 1819

41.64 Put a part at the grade cor made a  
mound of earth from a pit 4 lb 6.

81.64 Put the part at the Cor Dec 17. 18. 19. 20.

West Cometa on the 1st Dec 1819

40.00 Put a part at the grade cor made a  
mound of earth from a pit 4 lb 6.

80.00 Put a part at the Cor Dec 17. 18. 19. 20.  
made a mound of earth from a pit 4 lb 6.

East Pandom on the 1st Dec 1819

39.65 To a team 20 lb of the same at the

80.02 Entered at the same 25 lb of Dec cor.

West Cometa on the 1st Dec 1819

40.00 Put a part at the grade cor made a



Stamps No 790 Wampash & P...  
Cost

made a mound of earth from a pit 4th L.  
81.02 To the pit at the Cor to Dec 17. 8. 11 + 18.

Went Panam on the Vin at Dec 7 + 18  
Pan

81.90 Entered Pan Vin at the Dec cor.

Went Corrected on the Vin at Dec 7 + 18  
Pan

41.90 Det a part of the of Dec cor made a  
mound of earth from a pit 4th L.

81.90 To the pit at the Cor to Dec 7. 8. 11 + 18.

Went on the Vin at Dec 7 + 18  
Pan

39.00 Desend a tank R.

41.50 Det a part at the of Dec cor made  
a mound of earth from a pit 4th L.

42.50 Entered bottom on the cor.

81.50 Det a part at the Cor to Dec 5. 6. 7. 8.  
made a mound of earth pit 4th L.

Went Panam on the Vin at Dec 5 + 18  
Pan.

9.35 To a Steam 40 th in the sun AM  
81.00 Near the bottom.

81.19 Entered on the Vin 24 th of Dec cor.

Went Corrected on the Vin at Dec 5 + 18  
Pan.

41.19 Det a part at the of Dec cor made a  
mound of earth from a pit 4th L.

81.19 To the pit at the Cor to Dec 5. 6. 7. 8.



Quamhuip No 1908 Kungok 2 6 5 Pm Loria

West Pandan in the Xim bot Dec 617

44.50 Near the bottom of a small hole.

52.00 Top of the hill.

81.78 Entrance of Xim 25th of Dec 617

East Pandan in the Xim bot Dec 617

41.71 Det of soil at the 97 Dec 617 made a mound of earth from a pit 4th 6.

81.78 To the top of the hill Dec 5. 6. 7. 8.

North Pandan in the Xim bot Dec 516.

20.10 To a stream 40th mile from 17th

22.30 To the same stream 50th mile from 16th

23.75 To the same stream 40th mile from 17th

25.15 To the same stream 40th mile from 16th

27.50 To the same stream 40th mile from 17th

40.00 Det of soil at the 90 Dec 617 made a mound of earth from a pit 4th 6.

60.00 Near the bottom.

78.94 Entrance of Xim at the 516 Dec 516.

Col 19-137

I Certify that the foregoing is a true copy of the journals of Quamhuip No 1908 Kungok 2 6 5 Pm Loria, in record in this office.

Puriza General Secy  
H. L. Loria 1836

Gen Secy



*[Faint, illegible handwriting throughout the page, likely bleed-through from the reverse side.]*



The first part of the paper is devoted to a discussion of the general principles of the theory of the structure of the atom. It is shown that the structure of the atom is determined by the laws of quantum mechanics, and that the structure of the atom is determined by the laws of quantum mechanics.

The second part of the paper is devoted to a discussion of the general principles of the theory of the structure of the atom. It is shown that the structure of the atom is determined by the laws of quantum mechanics, and that the structure of the atom is determined by the laws of quantum mechanics.

The third part of the paper is devoted to a discussion of the general principles of the theory of the structure of the atom. It is shown that the structure of the atom is determined by the laws of quantum mechanics, and that the structure of the atom is determined by the laws of quantum mechanics.

The fourth part of the paper is devoted to a discussion of the general principles of the theory of the structure of the atom. It is shown that the structure of the atom is determined by the laws of quantum mechanics, and that the structure of the atom is determined by the laws of quantum mechanics.

The fifth part of the paper is devoted to a discussion of the general principles of the theory of the structure of the atom. It is shown that the structure of the atom is determined by the laws of quantum mechanics, and that the structure of the atom is determined by the laws of quantum mechanics.