

- County Boundary
- Incorporated Area
- Subdivision Boundary
- Parcel Boundary
- Block Boundary
- Lot Lines
- Parcel Point
- Right of Way
- Section Line
- Quarter
- Quarter Quarter
- Railroad
- Major Rivers
- 940860018** Parcel PIN
- Lot Number
- 912** Address Number
- Addition* Subdivision Name
- 940850019** Parcel Point PIN
- 2** Lot Number
- 40** Right of Way Dimension
- 175.00** Parcel Dimension
- 107.65** Lot Dimension

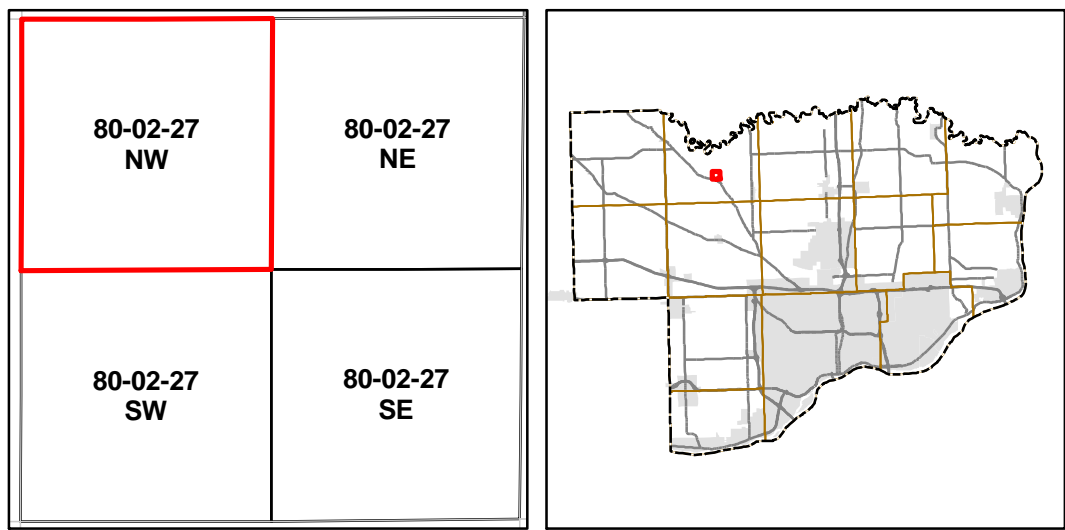

Tier 80 • Range 02 Section 27 NW Quarter Allens Grove Township



These maps are for illustration purposes only and may not be suitable for specific decision making. Scott County provides these maps for your personal use "as is". These plat maps are not to be construed as a survey or to be used as a survey, used for property boundary description, conveyance, or determination of legal title. Any use as such is strictly prohibited. If survey or deed information is needed, please see the Scott County Recorder and/or Auditor's Offices.

This information is prepared as an ongoing commitment to the public to provide quality and up-to-date information. While the Scott County GIS staff believes the data to be current and accurate, Scott County assumes no liability for any incorrect or incomplete information or data. The user of this information and data assumes all risk associated with such use.

1 inch = 200 feet



Map information valid as of **January 2012**

