

- County Boundary
- Incorporated Area
- Subdivision Boundary
- Parcel Boundary
- Block Boundary
- Lot Lines
- Parcel Point
- Right of Way
- Section Line
- Quarter
- Quarter Quarter
- Railroad
- Rivers
- 940860018** Parcel PIN
- 16** Lot Number
- 912** Address Number
- Addition* Subdivision Name
- 940850019** Parcel Point PIN
- 2** Block Number
- 40** Right of Way Dimension
- 175.00** Parcel Dimension
- 107.65** Lot Dimension

15-78-04 NE NW NW	15-78-04 NW NE NW	15-78-04 NE NE NW
15-78-04 SE NW NW	15-78-04 SW NE NW	15-78-04 SE NE NW
15-78-04 NE SW NW	15-78-04 NW SE NW	15-78-04 NE SE NW

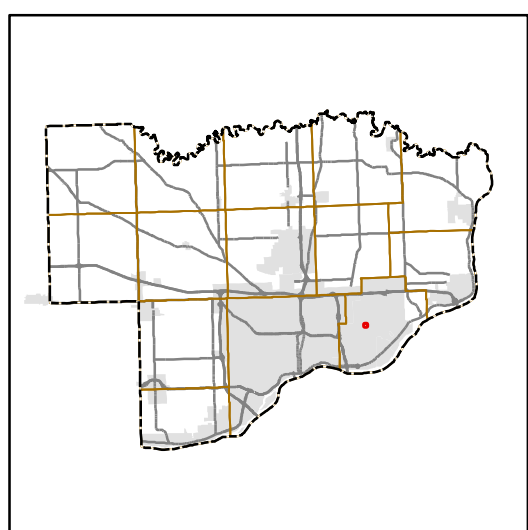

Tier 78 • Range 04

Section 15

SW NE NW Quarter

Pleasant Valley Township



These maps are for illustration purposes only and may not be suitable for specific decision making. Scott County provides these maps for your personal use "as is". These plat maps are not to be misconstrued as a survey or to be used as a survey, used for property boundary description, conveyance, or determination of legal title. Any use as such is strictly prohibited. If survey or deed information is needed, please see the Scott County Recorder and/or Auditor's Offices.

This information is prepared as an ongoing commitment to the public to provide quality and up-to-date information. While the Scott County GIS staff believes the data to be current and accurate, Scott County assumes no liability for any incorrect or incomplete information or data. The user of this information and data assumes all risk associated with such use.

1 inch = 50 feet



Map information valid as of **January 2012**

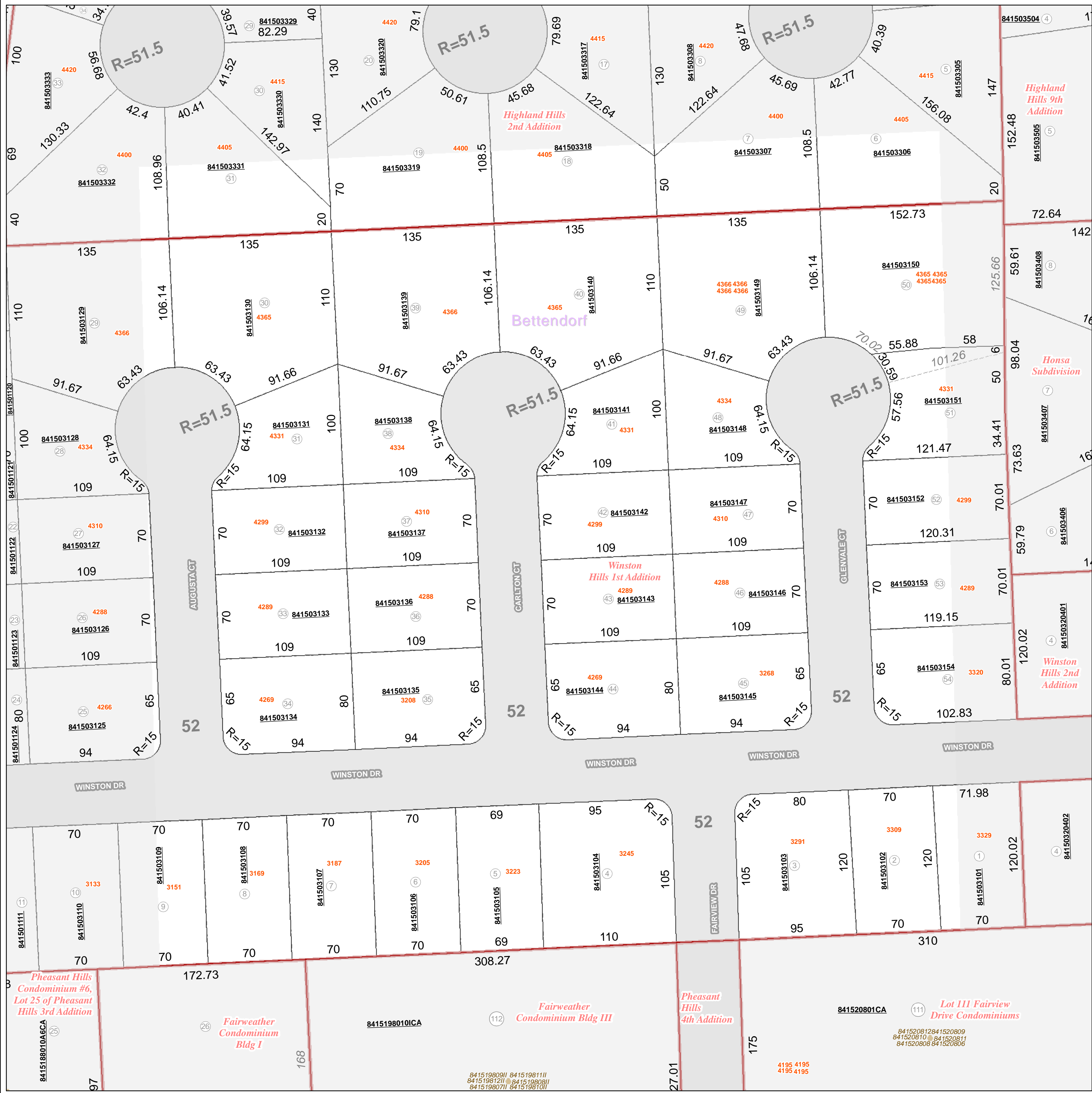

841519809|| 841519811||
841519812|| 841519813||
841519807|| 841519810||

4195 4195
4195 4195

841520812841520809
841520810 841520811
841520808 841520806

Pleasant Hills
Condominium #6,
Lot 25 of Pleasant
Hills 3rd Addition

Fairweather
Condominium
Bldg I

8415198010ICA

Fairweather
Condominium Bldg III

Pleasant
Hills
4th Addition

841520801CA

Lot 111 Fairview
Drive Condominiums