

- County Boundary
- Subdivision Boundary **940860018** Major Addition
- Parcel Boundary
- Block Boundary
- Lot Lines
- Parcel Point
- Right of Way
- Section Line
- Quarter
- Quarter Quarter
- Railroad
- Lot Number
- Address Number
- Subdivision Name
- Parcel Point PIN
- Block Number
- Right of Way Dimension
- Parcel Dimension
- Lot Dimension

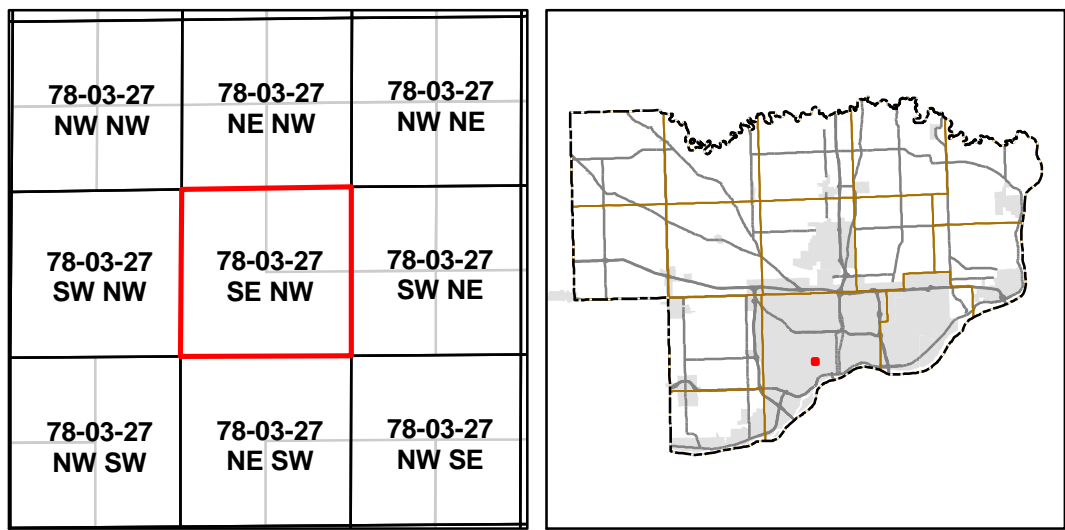

# Tier 78 • Range 03 Section 27 SE NW Quarter Davenport Township



These maps are for illustration purposes only and may not be suitable for specific decision making. Scott County provides these maps for your personal use "as is". These plat maps are not to be misconstrued as a survey or to be used as a survey, used for property boundary description, conveyance, or determination of legal title. Any use as such is strictly prohibited. If survey or deed information is needed, please see the Scott County Recorder and/or Auditor's Offices.

This information is prepared as an ongoing commitment to the public to provide quality and up-to-date information. While the Scott County GIS staff believes the data to be current and accurate, Scott County assumes no liability for any incorrect or incomplete information or data. The user of this information and data assumes all risk associated with such use.

1 inch = 100 feet



Map information valid as of **January 2012**

