

NOTE: THIS N.E. 1/4 OF SEC. 1-78-1
IS IN MUSCATINE COUNTY

N.E. 1/4 SEC. 1-78-1
TOWN OF WALCOTT
SCALE: 1" = 200'

17-A

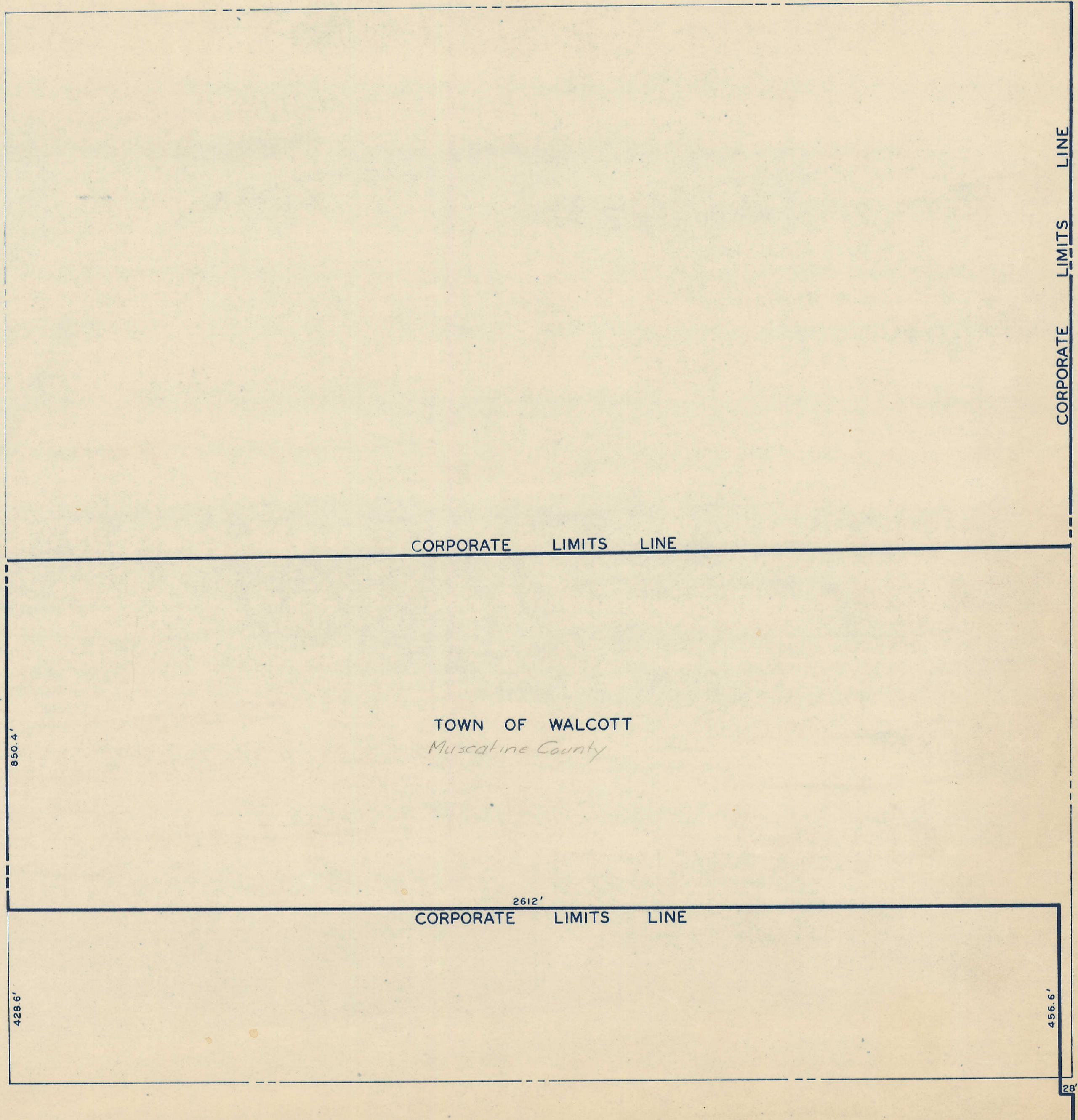

CORPORATE LIMITS LINE

CORPORATE LIMITS LINE

TOWN OF WALCOTT
Muscatine County

CORPORATE LIMITS LINE

(17) SEC. 6 BLUE GRASS TWP.
SCOTT COUNTY

456.6'

28