

1

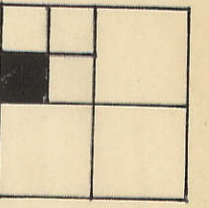

23 SEC.26

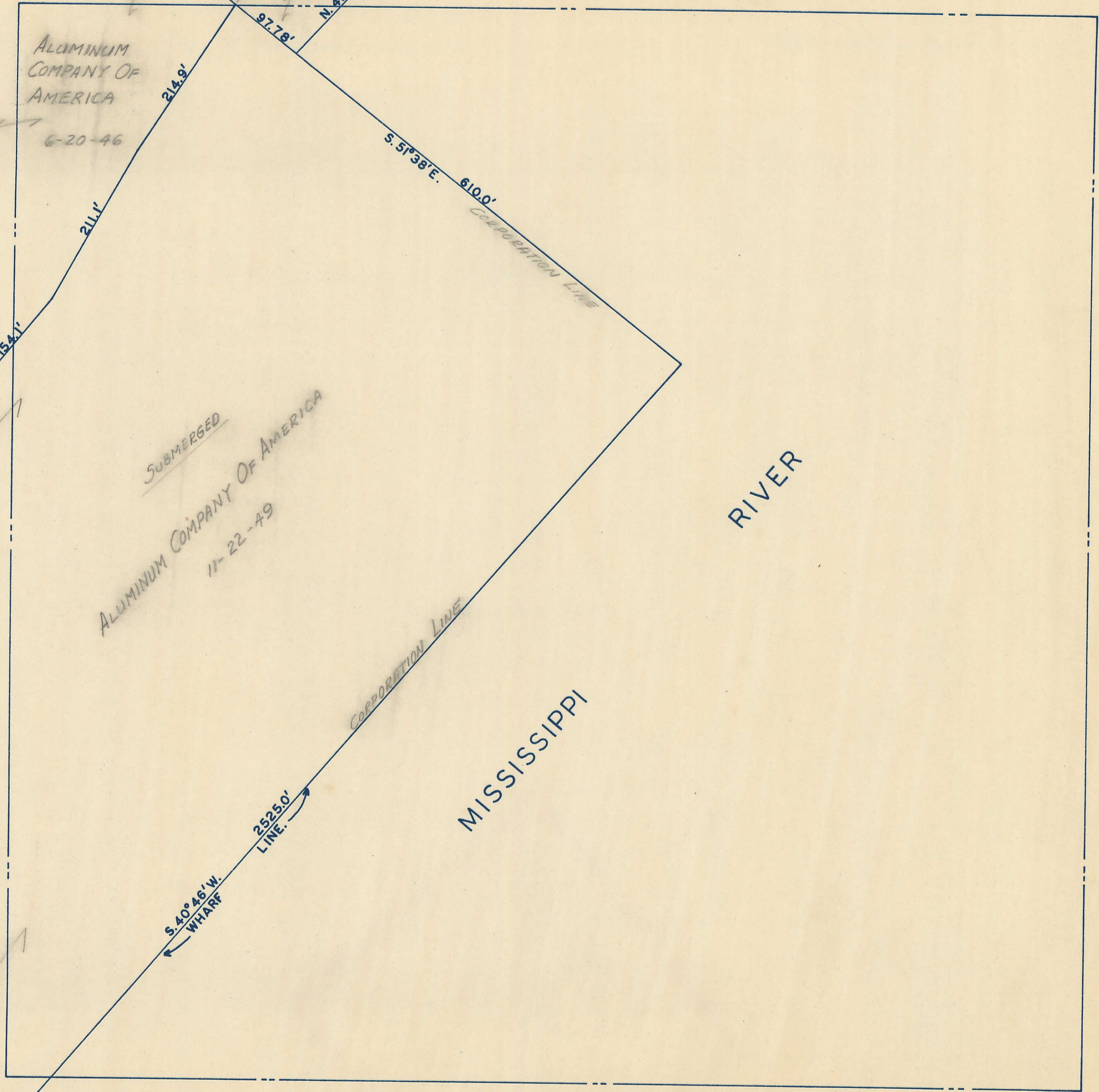

ALUMINUM  
COMPANY OF  
AMERICA

6-20-46

SUBMERGED

ALUMINUM COMPANY OF AMERICA  
11-22-49

RIVER

MISSISSIPPI

RIVER BANK

3-15-63

N. 42° 28' E  
1510.0'

S. 51° 38' E.  
610.0'

CORPORATION LINE

CORPORATION LINE

2525.0'  
LINE.

S. 40° 46' W.  
WHARF

214.9'

211.1'

154.1'

97.78'

1135'