

PRINCETON TOWNSHIP
NW 1/4 NE 1/4 SEC 2-79-5

TRANSFER PAGE 81ds-378

19

W. line NE 1/4 SEC 2-79-5

RIVERCREST
ESTATES LTD
5-11-84

State of Iowa 7-10-79

U.S. RTE 67

D. R. I. & N.W. RR.

TRACT 1
Survey #
85175-98
7-7-98

23

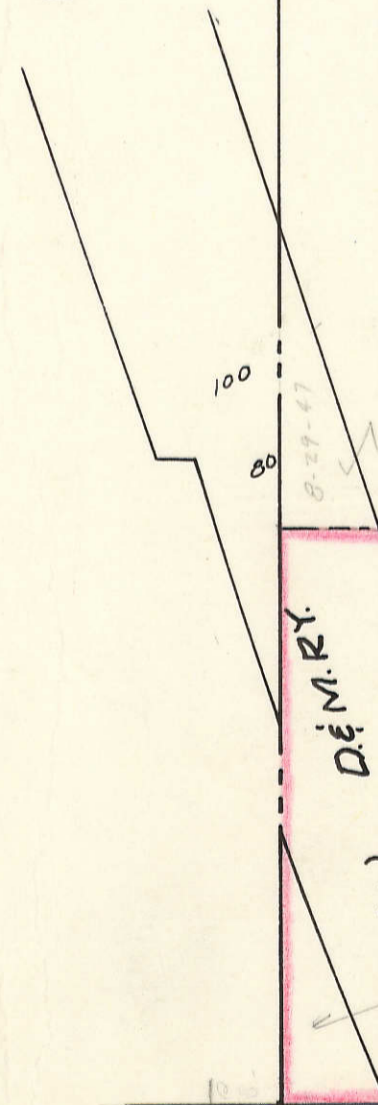

264
Michael & Debra
Irving
7-28-94
22431-94

165
JOHN F NELSON TRUST
PINNEO'S
6-22-92
16775-92
1-16-03
2574-03

330
Wold,
Bruce & Meghan
6-4-2002
81553-02

791
KEVIN +
AMY
LAMFERS
12-3-01
43110-01

210
ESTATE
5
ROBERT
HARPER
11812-2007
4-26-2007

JAMES L COSSELLMAN
5-30-2003
25912-2003

714
TERRY M & DENA L
CANNIE
5-22-03
20684-2006
7-17-2006

4
PEGGY
KNIGHT
5-10-04
16134-04

4
YOUNGERS
LIVING
TRUST
11-6-03
58155-03

3
JOHNSON
MFG.
Co.
3-13-65
Parcel 2

Center SEC 2-79-5

S. line NE 1/4 SEC 2-79-5

TRANSFER PAGE 147L-654

37