

Transfer Page 567 ST.

25	17	SAHNER & Joann CORDERO
"	18	10-27-78
"	19	
"	20	LLOYD & MIELA
"	21	CLAUSSEN 5-20-04
"	22	11-6-04
"	23	
25	24	140

25	8	
"	7	C.N. line
"	6	
"	5	
"	4	
"	3	GERALD D. HORNER et al
"	2	6-24-64 7-28-83 lot
25	1	140

SE 1/4 SE 1/4 SW 1/4 SEC 12

80 ST.

80	8	
"	9	
"	10	12-3-81
60		140

80	3	BERNARD, JR. & ALLISON K. SCHOONOVER 5-21-74
"	2	
"	1	HERMAN H. WITT 6-7-58
60		10-8-70 140

40 ST.

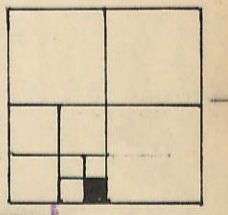

Transfer Page 568

42 Transfer Page 562 SALINA

25	13	THOMAS E. PHILLIPS & LORETTA I. PHILLIPS
"	14	
"	15	11-17-72
"	16	George Shreves
"	17	
"	18	1812-28-05 43234-05
"	19	
"	20	LORI A. MIZUR 31098-01 9-7-01
"	21	
"	22	
"	23	
25	24	140

25	12	Kendrick Glenn & Linda
"	11	8-13-2003 42,354-0330
"	10	
"	9	
"	8	
"	7	
"	6	
"	5	
"	4	
"	3	
"	2	
25	1	140

McCAUSLAND

80 WHITE

60	6	
"	7	
"	8	
"	9	
60	10	
		140

20	5	
"	4	
"	3	
"	2	
"	1	DALE A LINDLE & LISA D LEMAN 32934-2006 10-18-2006
60		140

40 BORDER

1/4 Sec. Line CORPORATION

Transfer Page 561

160' C.W. line SE 1/4 SW 1/4 SEC 12

SEC. LINE BETW. 12 & 13

Princeton Agency 2 1/2 Acs. 1-10-84

1/4 Corner SEC 12-80-42