

10 11
15 14

NW Corner SEC 14-79-3

LECLAIRE ROAD

Section line between SECS 11 & 14

405 80 BRENN J WOOD 9145-2004 3-22-2004	401 80 LUTHERAN CHURCH 16011-92 6-12-92	325 80 Staples, W Michael Gayle E 8-14-2000 23609-00	321 70 MADINE Powe 6-23-61 11-4-82 CET	317 70 THOMAS J. FRANKSON APRIL A 10-9-76 2629-76	307 70 BRYAN S. SENAK 44586-500 3-29-2010	305 68 DAVID C & CAROLYN K TUBBS 10-5-2005 33344-2005	215 130.5 STEVEN C JOAN E PETERSEN 10-14-92 28436-92	209 59.25 HARDMAN FAMILY TRUST 31678-2005 9-22-2005	30 30 DEREK A JENNIFER L SANDKNOP 30332-2004 8-25-04	205 88.5 RYAN N GRUNWALD 9-22-2005 31640-05	113 90 DANNY DOOLEY 5-19-2004 17410-04	109 120 HARRY E. STALL 5-8-29 10-15-49 1-30-75	60 60 ANDREW J CRONKLETON 9047-2002 3-4-2002	88.07 88.07
---	---	--	--	--	---	--	--	--	---	--	---	---	---	----------------

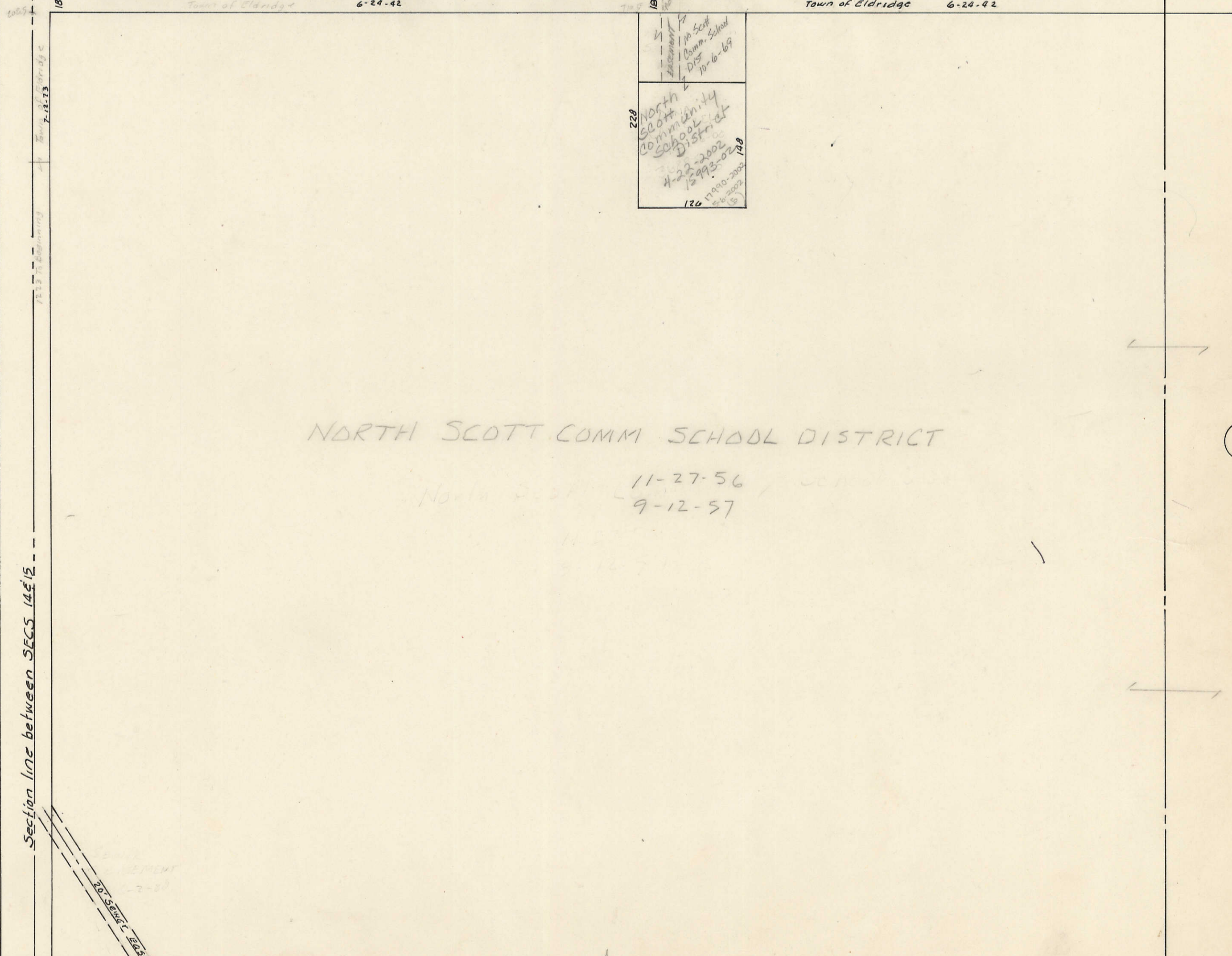

SEC 15

7

NORTH SCOTT COMM SCHOOL DISTRICT

11-27-56

9-12-57

3

17