

54

ALDI INC
5-20-91 (3)
09957-91
SCHICK'S SECOND
SUBDIVISION
TRANSFER PAGE 9-1216
LOT 6

MARK D. & CORAL B JOHNSON
5-16-91 9831-91
444.8 432.3

Daniel Wallace
1-16-2004
1583-2004

TRANSFER PAGE 64-202

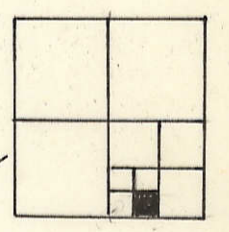

3
4
HALSEY'S
ADDITION

ROLFF

Rolff Street Properties
3-4-2003
10622-03
JERRY L. DAVIS
10-17-89
18177-89

SURVEY
2004-02470
1-26-2004

60

LOT 1

KELLER PATTERN CO INC
12-30-06
40065-06

58

SCHICK'S **SUBDIVISION**

TRANSFER PAGE 15-716

BLUE PROPERTIES, LLC
10-16-00
30296-2000
LOT 2

STREET

S. line SEC. 33-78-3

VOL. R SEC 4-77-3

6