

(45)

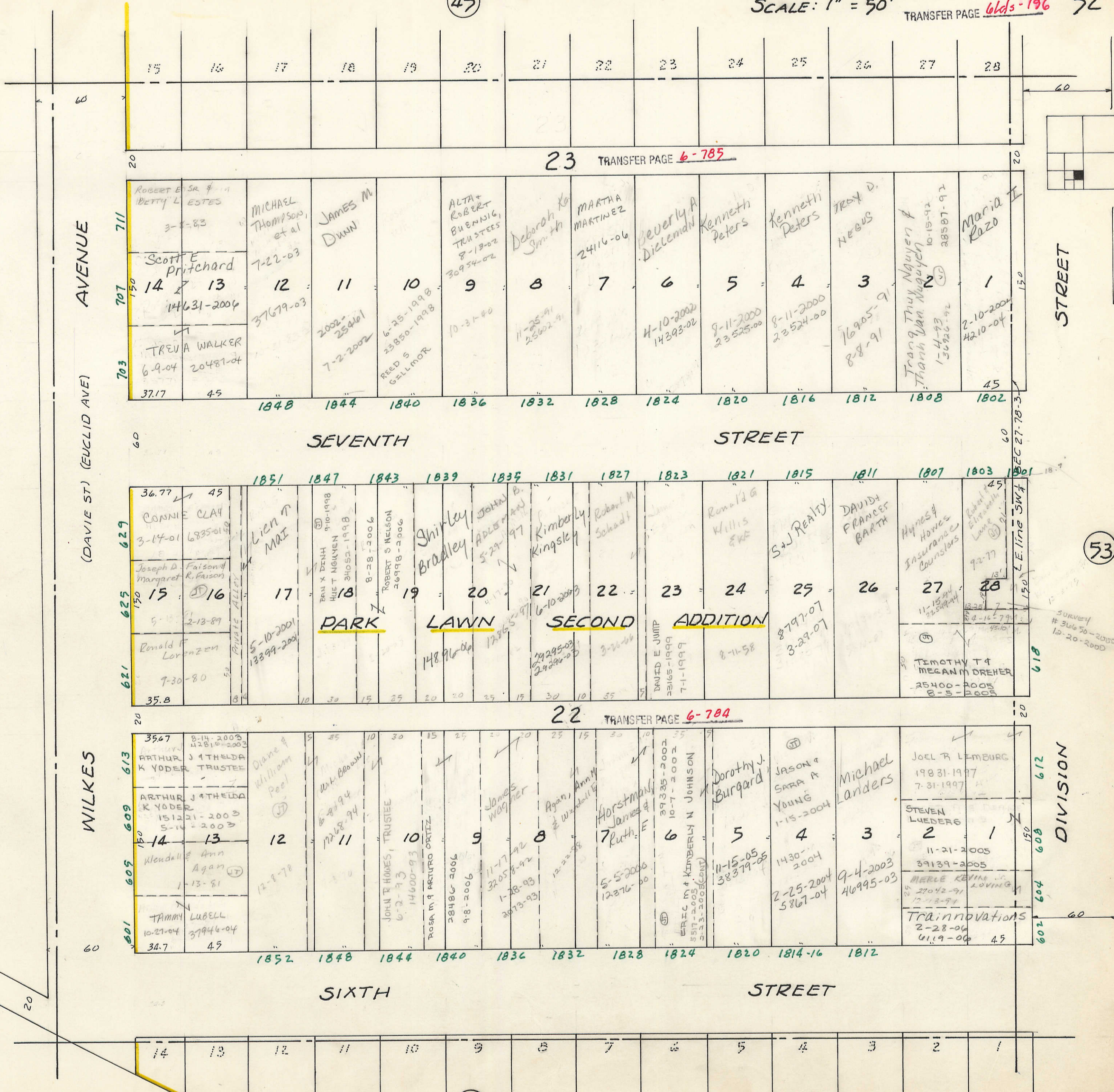

15	16	17	18	19	20	21	22	23	24	25	26	27	28
----	----	----	----	----	----	----	----	----	----	----	----	----	----

ROBERT E. SR & BETTY L. ESTES 3-8-83	MICHAEL THOMPSON et al 7-22-03	JAMES M. DUNN 2002-25461 7-2-2002	ALTA & ROBERT BURNING TRUSTEES 8-13-02 30934-02	Deborah K. Smith 11-25-91 23602-91	MARTHA MARTINEZ 24116-06	Beverly A. Diceman 4-10-2002 14393-02	Kenneth Peters 8-11-2000 23525-00	Kenneth Peters 8-11-2000 23524-00	TROY D. NEBUS 16905-91 8-8-91	Trang Thuy Nguyen & Thanh Van Nguyen 10-15-92 38507-92 1-4-93 36926-92	Maria I. Razo 2-10-2002 4210-04		
14	13	12	11	10	9	8	7	6	5	4	3	2	1
14631-2004	37679-03	2002-25461 7-2-2002	6-25-1998 23850-1998	10-31-80	11-25-91 23602-91	24116-06	4-10-2002 14393-02	8-11-2000 23525-00	8-11-2000 23524-00	16905-91 8-8-91	10-15-92 38507-92 1-4-93 36926-92	2-10-2002 4210-04	
1848	1844	1840	1836	1832	1828	1824	1820	1816	1812	1808	1802		

1851	1847	1843	1839	1835	1831	1827	1823	1821	1815	1811	1807	1803	1801
------	------	------	------	------	------	------	------	------	------	------	------	------	------

CONNIE CLAY 3-14-01 6835-01	Lien M. MAI 5-10-2001 13399-2001	PAU X. DINH 9-10-1998 34052-1998	SHIRLEY BRADLEY 5-29-97	JOHN B. ADLER 5-29-97	KIMBERLY KINGSLEY 6-10-2003	ROBERT H. SCHADT 3-2-06	DAVID E. JUMP 8-11-58 23165-1999 7-1-1999	RONALD G. WILLIS 8-11-58	S+J REALTY 8797-07 3-29-07	DAVID & FRANCES BARTH 11-15-94 23549-94	HYNES & HOWES Insurance Counselors 9-27-77	ROBERT L. LANGE 9-27-77	TIMOTHY T. MEGAN M. DREHER 8-5-2005 25400-2005
15	16	17	18	19	20	21	22	23	24	25	26	27	28
2-13-89	5-10-2001 13399-2001	9-10-1998 34052-1998	5-29-97	5-29-97	6-10-2003	3-2-06	8-11-58 23165-1999 7-1-1999	8-11-58	8797-07 3-29-07	11-15-94 23549-94	9-27-77	9-27-77	8-5-2005 25400-2005
1851	1847	1843	1839	1835	1831	1827	1823	1821	1815	1811	1807	1803	1801

TRANSFER PAGE 6-784 22

ARTHUR J. & THELDA K. YODER TRUSTEE 151221-2003 5-14-2003	Diane & William Peel 12-9-78	WILL BROWN 6-8-94 1268-94	JOHN R. HOWES, TRUSTEE 6-2-93 14600-93	ROSA M. & ARTURO ORTIZ 28486-2006 9-8-2006	JAMES WAGNER 11-17-92 32058-92	Agan, Amy & W. Zaball 12-22-88	Horstmann, James & Ruth 5-5-2008 12376-00	ERIC M. & KIMBERLY N. JOHNSON 5-17-2003 233-2003(Cont)	Dorothy J. Burgard 11-15-05 38379-05	JASON & SARA A. YOUNG 1-15-2004 1430-2004	Michael Landers 9-4-2003 46995-03	JOEL R. LEMBURG 19831-1997 7-31-1997	STEVEN LUEDERS 11-21-2005 39139-2005
14	13	12	11	10	9	8	7	6	5	4	3	2	1
10-27-04 37946-04	12-9-78	6-8-94 1268-94	6-2-93 14600-93	28486-2006 9-8-2006	11-17-92 32058-92	12-22-88	5-5-2008 12376-00	5-17-2003 233-2003(Cont)	11-15-05 38379-05	1-15-2004 1430-2004	9-4-2003 46995-03	19831-1997 7-31-1997	11-21-2005 39139-2005
1852	1848	1844	1840	1836	1832	1828	1824	1820	1814-16	1812			

14	13	12	11	10	9	8	7	6	5	4	3	2	1
----	----	----	----	----	---	---	---	---	---	---	---	---	---

TAMMY LUBELL 10-27-04 37946-04													
34.7	4.9												
1852	1848	1844	1840	1836	1832	1828	1824	1820	1814-16	1812			

(51)

(53)

(61)