

(40)

Transfer Page 623

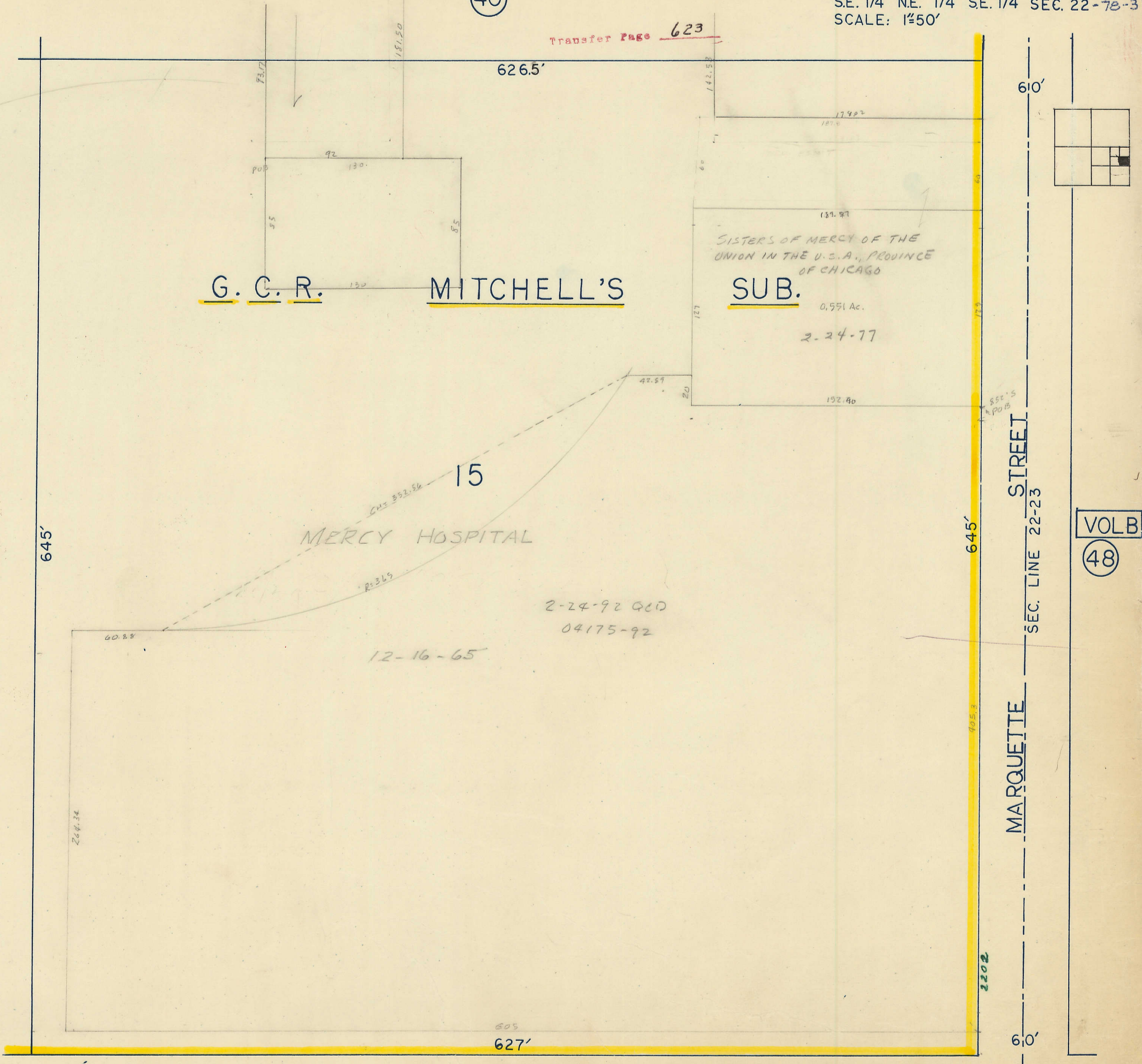

G. C. R.      MITCHELL'S

SUB.

SISTERS OF MERCY OF THE  
UNION IN THE U.S.A., PROVINCE  
OF CHICAGO

0.951 Ac.

2-24-77

MERCY HOSPITAL

15

2-24-92 QCD

04175-92

12-16-65

SEE'S  
POB

STREET  
SEC. LINE 22-23

MARQUETTE

VOLB

(48)

(42)

645'

627'

LOMBARD (GASTON) ST.

60'

60'

(56)