

SECTION 9

TOWNSHIP 78 NORTH, RANGE 4 EAST,

5<sup>TH</sup> PRINCIPAL MERIDIAN

~~PLEASANT VALLEY TOWNSHIP~~

SCOTT COUNTY, IOWA

TRANSFER PAGE 210

SCALE: 1" = 330'

SECTION 4

PAGE 13

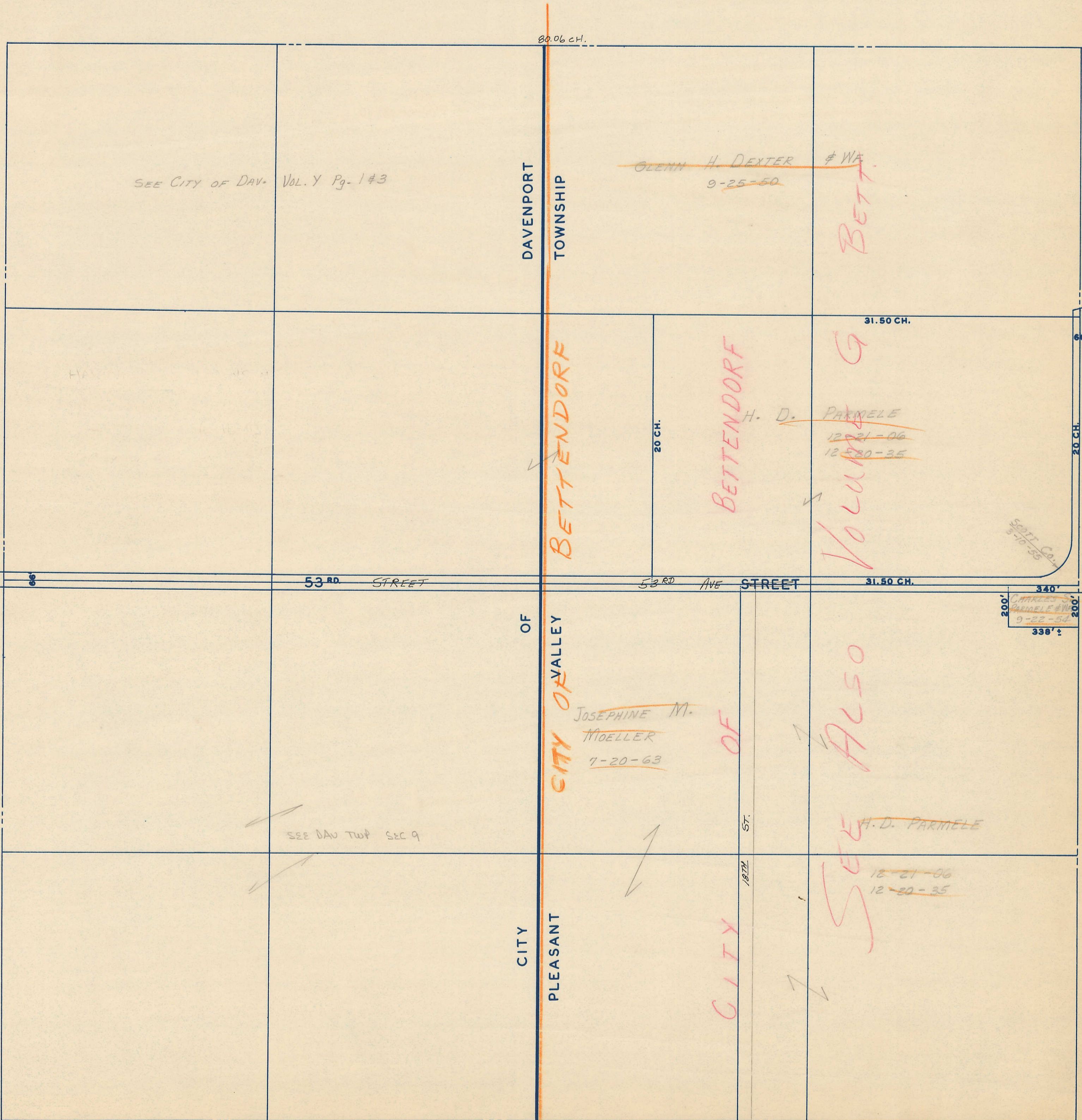

PAGE

SECTION

PAGE 6

SECTION 10

①

③

SECTION 16 OF CITY BETTENDORF PAGE 5 & 7 VOL. D

⑤

①