

46TH STREET
CROW - GREEK ROAD DAVENPORT
BETTENDORF

8,9
17/16

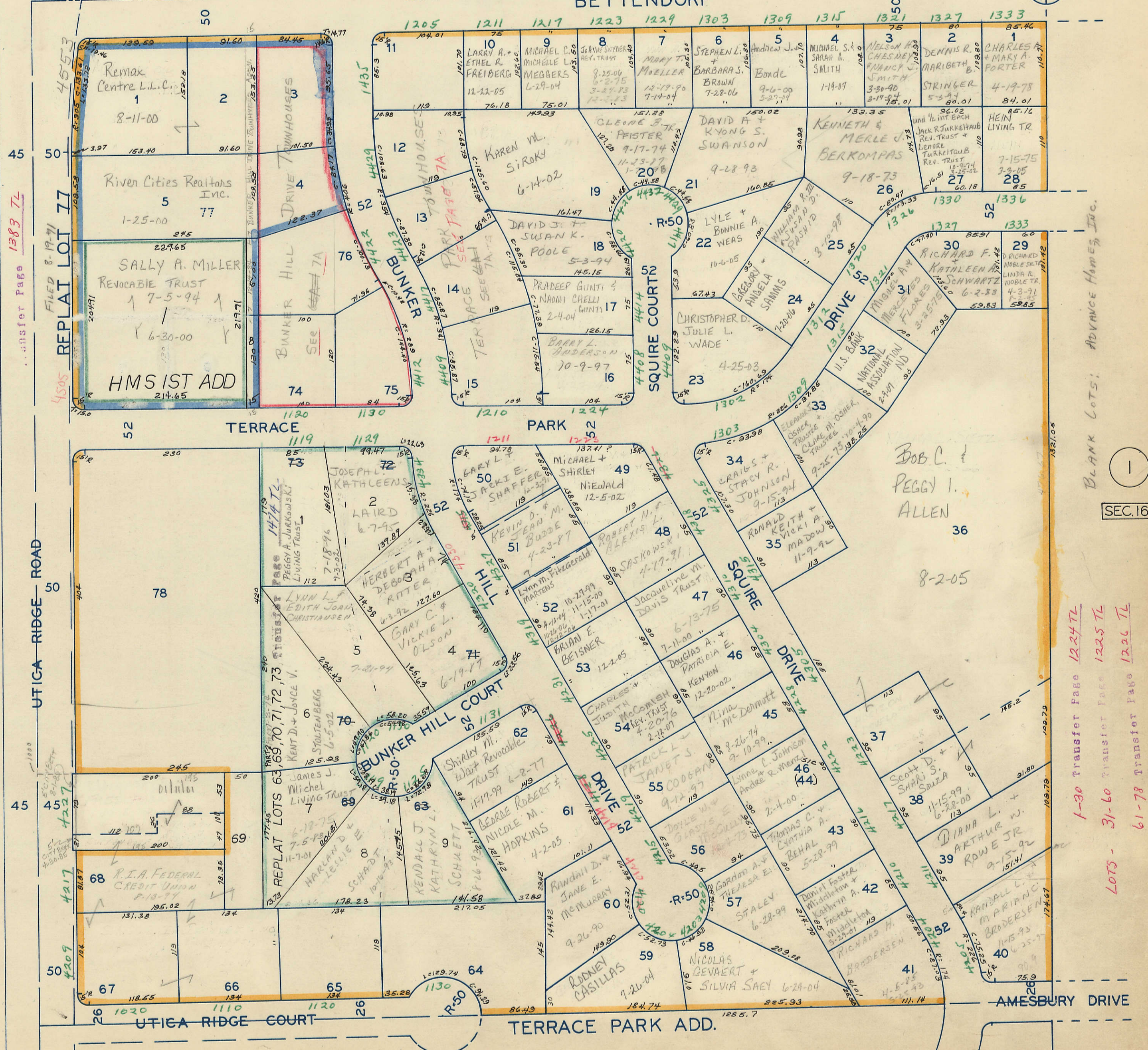

Transfer Page 1383 TL

5

BLANK LOTS: ADVANCE HOMES, INC.

SEC. 16

1-30 Transfer Page 1224 TL
31-60 Transfer Page 1225 TL
61-78 Transfer Page 1226 TL

23

TERRACE PARK TOWNHOUSES

(ON LOTS 11, 12, 13, 14, 15 TERRACE PARK)

BUNKER HILL DRIVE

4451	ADAIR HOLDINGS, LLC	12-21-06
4455	RODNEY L. CHRISTIE	6-20-90
4463	WILLIAM M. GRIEBEL	4-26-04
4467	BRENDA D. BRIBSTON	02-04-03 8-3-01
4475	LANGE LIVING TRUST	5-3-76 6-24-02
4477	DONALD R. & KATHRYN J. NELSON	4-20-07
4487	DEBORAH A. SCHMELTZER	7-28-03
4473	BRENDA S. STANDLEY	8-17-93
4499	JOAN M MURPHY	1-4-78
4505	MYONG C. FENDER	11-18-02
4509	JOHN A & ROSEMARIE JOHN	1-16-79
4511	BRENDA K. BREWER	7-13-05
4523	MARY ANN GOODMAN	11-30-93
4531	CLARK M. & NANCY HARTZELL	2-14-89
4535	KENNETH D. DESTREICH + DOROTHY DEE PIPER	11-14-02
4543	JOSEPH A. Mc CAFFREY	10-10-96 9-23-87
4547	MARY K. HAMMITT	6-16-05
4551	WILLIAM T. & MARGARET A. LEWIS	8-18-04
4557	QC SPORTS VENTURES, INC.	9-1-06
4567	RICHARD M. & VIRGINIA A. SEIFERT TRUST	1-20-97 12-28-81
4571	JOAN E. & KATHLEEN A. DETERMAN	7-22-04

ADVANCE HOMES INC

#6350-81 4-22-81

BUNKER HILL DRIVE TOWNHOUSES

#11645-80 (ON LOT 74, 75, 76 & LOTS 4 REFRAT LOT 77 TERRACE PARK)

4538	Schwalm Living TRUST	11-27-01 10-17-00 11-20-01 10-2-97
4542	TRUCE T. & KRISTY S. ORDONA	12-10-86 7-2-92 8-13-80
4554	EDWARD E. SR. + CHARLENE E. MERRITT	3-21-02
4558	ROSEMARY A. MARTEN	12-2-93
4566	Paul E. & Joyce E. Bohnsack	6-15-84 6-4-84
4570	ROGER H. + Delores J. HILL	10-29-99
B1	TRUDY LYNN WILSON	3-16-05
B2	JAMES A. & PATRICIA J. BARNES	6-1-04
B3	EDWARD G SAUER	8-14-96 4-11-94
B4	ALLEN P. KUIDERA	9-19-05
A1	CONSTANCE P. CARLSON	12-13-95
A2	JOHN D. + SHARON B. HELMING	1-17-97
A3	ROBERTA C. CERYANEC - HAINNESS	10-5-98
A4	ROGER H. + Mary Lou Keeester	2-4-02
A5	SUSAN I + CRAIG D. CHRISTENSEN	11-6-98
A6	VERNON L. + BETTY A. VANCE	9-25-06